

CATALOGO CF 04

AZIENDA CON  
SISTEMA DI GESTIONE QUALITA'  
CERTIFICATO DA DNV  
ISO 9001

# PRODOTTI PER SALDATURA A SCARICA CAPACITIVA E AD ARCO CORTO



 **CARUSO**®  
F A S T E N E R S



## VISUALIZZA IL PRODOTTO CLICCANDO SU TIPOLOGIA O PAGINA PER TORNARE ALL'INDICE, CLICCARE IL PULSANTE "INDICE"

VIEW THE PRODUCT BY CLICKING ON TYPE OR PAGE.

RETURN TO THE INDEX BY CLICKING THE "INDEX" BUTTON

### PRIGIONIERI **CFPT** / CFPT-THREADED STUDS

|   |   |
|---|---|
| FERRO RAMATO 4.8 / ST 37 COPPER PLATED          | 5 |
| ACCIAIO INOX A2-50 (1.4301/3) / STAINLESS STEEL | 6 |
| ALLUMINIO AIMG3 / ALLUMINIUM                    | 7 |

### PERNI LISCI **CFUT** / CFUT-NO THREADED STUDS

|   |    |
|---|----|
| FERRO RAMATO 4.8 / ST 37 COPPER PLATED          | 8  |
| ACCIAIO INOX A2-50 (1.4301/3) / STAINLESS STEEL | 9  |
| ALLUMINIO AIMG3 / ALLUMINIUM                    | 10 |

### BUSSOLE **CFIT** / CFIT-TAPPED STUDS

|   |    |
|---|----|
| FERRO RAMATO 4.8 / ST 37 COPPER PLATED          | 11 |
| ACCIAIO INOX A2-50 (1.4301/3) / STAINLESS STEEL | 12 |
| ALLUMINIO AIMG3 / ALLUMINIUM                    | 13 |

### INSUL PINS **ISO** / ISO-NAILS

|   |    |
|---|----|
| FERRO RAMATO 4.8 - ACCIAIO INOX A2-50 / COPPER PLATED - STAINLESS STEEL | 14 |
|---|----|

### FASTON SEMPLICI **FI** / EARTH TAGS

### FASTON DOPPI **F2** / TWIN EARTH TAGS

|  |    |
|--|----|
| FERRO RAMATO 4.8 - ACCIAIO INOX A2-50 - OTTONE - ALLUMINIO<br>COPPER PLATED - STAINLESS STEEL - BRASS - ALLUMINIUM | 15 |
|--|----|

### PRIGIONIERI PER ARCO CORTO **FD** / SHORT CYCLE STUDS

|  |    |
|--|----|
| FERRO RAMATO 4.8 - ACCIAIO INOX A2-50 (1.4301/3) / ST 37 COPPER PLATED - STAINLESS STEEL | 16 |
|--|----|

### PRIGIONIERI **CHRISTMAS CD E SD** / CHRISTMAS TREE STUDS CD AND SD

|  |    |
|--|----|
| FERRO RAMATO 4.8 / ST 37 COPPER PLATED | 16 |
|--|----|

### PRIGIONIERI **AUTOPULENTI** / COLOUR GRAVE STUDS

|  |    |
|--|----|
| FERRO RAMATO 4.8 / ST 37 COPPER PLATED | 16 |
|--|----|

# DIMENSIONE STANDARD

STANDARD DIMENSIONS

## PRIGIONIERI CFPT / THREADED STUDS CFPT

| $d_1$ | $l_1$<br>+0.60                    | $d_3$<br>±0.2 | $d_4$<br>±0.08 | $l_3$<br>+0.05 | h<br>max. | n   | $l_2$                   | $\alpha$ |
|-------|-----------------------------------|---------------|----------------|----------------|-----------|-----|-------------------------|----------|
| M3    | Vedi dimensioni<br>See dimensions | 4.5           | 0.6            | 0.55           | 0.7-1.4   | 1.5 | $l_2 \approx l_1 - 0,3$ | 3        |
| M4    |                                   | 5.5           | 0.65           |                |           |     |                         |          |
| M5    |                                   | 6.5           | 0.75           | 0.80           | 0.8-1.4   | 2   |                         |          |
| M6    |                                   | 7.5           |                |                |           |     |                         |          |
| M8    |                                   | 9.0           | 0.85           | 3              |           |     |                         |          |

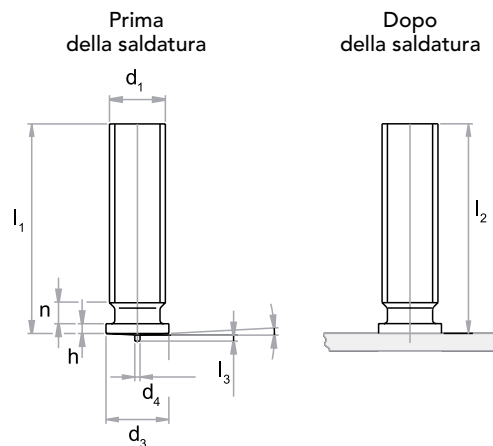

## PERNI LISCI CFUT / PIN CFUT

| $d_1$<br>±0.1 | $l_1$<br>+0.60                    | $d_3$<br>±0.2 | $d_4$<br>±0.08 | $l_3$<br>+0.05 | h       | $l_2$                   | $\alpha$<br>±1 |
|---------------|-----------------------------------|---------------|----------------|----------------|---------|-------------------------|----------------|
| Ø 3           | Vedi dimensioni<br>See dimensions | 4.5           | 0.6            | 0.55           | 0.7-1.4 | $l_2 \approx l_1 - 0,3$ | 3              |
| Ø 4           |                                   | 5.5           | 0.65           |                |         |                         |                |
| Ø 5           |                                   | 6.5           | 0.75           | 0.80           | 0.8-1.4 |                         |                |
| Ø 6           |                                   | 7.5           |                |                |         |                         |                |
| Ø 7           |                                   | 9.0           | 0.85           |                |         |                         |                |
| Ø 8           |                                   |               |                |                |         |                         |                |

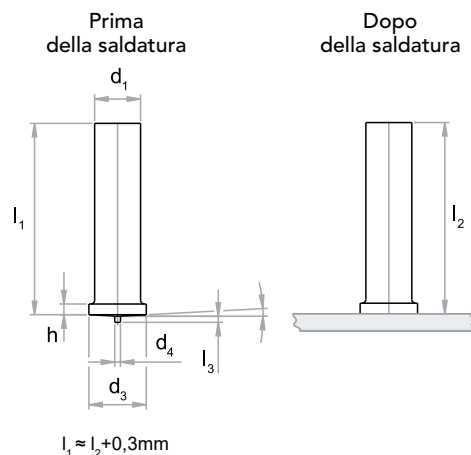

## BUSSOLE CFIT / TAPPED STUD CFIT

| $d_1$ | $l_1$<br>+0.60                    | $d_3$<br>±0.2 | $d_4$<br>±0.08 | $l_3$<br>+0.05 | h       | $d_2$ | b | $l_2$                   | $\alpha$<br>±1 |
|-------|-----------------------------------|---------------|----------------|----------------|---------|-------|---|-------------------------|----------------|
| Ø 5   | Vedi dimensioni<br>See dimensions | 6.5           | 0.75           | 0.80           | 0.8-1.4 | M3    | 5 | $l_2 \approx l_1 - 0,3$ | 3              |
| Ø 6   |                                   | 7.5           |                |                |         | M4    | 6 |                         |                |
| Ø 7.1 |                                   | 9.0           | 0.85           | M5             | 7.5     |       |   |                         |                |
| Ø 8   |                                   |               |                | M6             |         |       |   |                         |                |

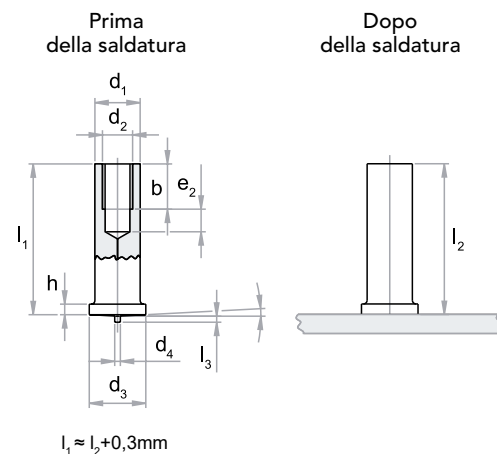

ATTENZIONE: LE CARATTERISTICHE DIMENSIONALI O LE PRESTAZIONI POSSONO ESSERE MODIFICATE SENZA PREAVVISO.

> Misure e materiali speciali su richiesta  
> On special request modified dimensions and materials can be supplied



| CODICE<br>ORDER-NO. | Misura<br>Dimensions      | Peso<br>kg/1000 pezzi<br>Weight<br>kg/1000 pcs |
|---------------------|---------------------------|--|
| <b>CF03ARPR2.5</b>  | M 2,5 x Lungh./<br>Lengh. | Solo su richiesta<br>Only on demand            |
| <b>CF03ARPR306</b>  | M 3 x 6                   | 0,33   |
| <b>CF03ARPR308</b>  | M 3 x 8                   | 0,42   |
| <b>CF03ARPR310</b>  | M 3 x 10                  | 0,49   |
| <b>CF03ARPR312</b>  | M 3 x 12                  | 0,57   |
| <b>CF03ARPR315</b>  | M 3 x 15                  | 0,70   |
| <b>CF03ARPR316</b>  | M 3 x 16                  | 0,73   |
| <b>CF03ARPR320</b>  | M 3 x 20                  | 0,85   |
| <b>CF03ARPR325</b>  | M 3 x 25                  | 0,93   |
| <b>CF03ARPR330</b>  | M 3 x 30                  | 1,12   |
| <b>CF03ARPR335</b>  | M 3 x 35                  | 1,55   |
| <b>CF03ARPR340</b>  | M 3 x 40                  | 1,76   |
| <b>CF03ARPR406</b>  | M 4 x 6                   | 0,50   |
| <b>CF03ARPR408</b>  | M 4 x 8                   | 0,70   |
| <b>CF03ARPR410</b>  | M 4 x 10                  | 0,80   |
| <b>CF03ARPR412</b>  | M 4 x 12                  | 0,95   |
| <b>CF03ARPR415</b>  | M 4 x 15                  | 1,11   |
| <b>CF03ARPR416</b>  | M 4 x 16                  | 1,20   |
| <b>CF03ARPR420</b>  | M 4 x 20                  | 1,54   |
| <b>CF03ARPR425</b>  | M 4 x 25                  | 1,92   |
| <b>CF03ARPR430</b>  | M 4 x 30                  | 2,30   |
| <b>CF03ARPR435</b>  | M 4 x 35                  | 2,65   |
| <b>CF03ARPR440</b>  | M 4 x 40                  | 3,19   |
| <b>CF03ARPR445</b>  | M 4 x 45                  | 3,57   |
| <b>CF03ARPR508</b>  | M 5 x 8                   | 1,08   |
| <b>CF03ARPR510</b>  | M 5 x 10                  | 1,35   |
| <b>CF03ARPR512</b>  | M 5 x 12                  | 1,60   |
| <b>CF03ARPR515</b>  | M 5 x 15                  | 1,83   |
| <b>CF03ARPR516</b>  | M 5 x 16                  | 1,95   |
| <b>CF03ARPR520</b>  | M 5 x 20                  | 2,55   |
| <b>CF03ARPR525</b>  | M 5 x 25                  | 3,15   |
| <b>CF03ARPR530</b>  | M 5 x 30                  | 3,75   |
| <b>CF03ARPR535</b>  | M 5 x 35                  | 4,38   |
| <b>CF03ARPR540</b>  | M 5 x 40                  | 5,00   |
| <b>CF03ARPR545</b>  | M 5 x 45                  | 5,87   |
| <b>CF03ARPR550</b>  | M 5 x 50                  | 6,50   |

| CODICE<br>ORDER-NO. | Misura<br>Dimensions     | Peso<br>kg/1000 pezzi<br>Weight<br>kg/1000 pcs |
|---------------------|--------------------------|--|
| <b>CF03ARPR608</b>  | M 6 x 8                  | 1,60   |
| <b>CF03ARPR610</b>  | M 6 x 10                 | 1,85   |
| <b>CF03ARPR612</b>  | M 6 x 12                 | 2,10   |
| <b>CF03ARPR615</b>  | M 6 x 15                 | 2,65   |
| <b>CF03ARPR616</b>  | M 6 x 16                 | 2,65   |
| <b>CF03ARPR620</b>  | M 6 x 20                 | 3,40   |
| <b>CF03ARPR625</b>  | M 6 x 25                 | 4,15   |
| <b>CF03ARPR630</b>  | M 6 x 30                 | 4,90   |
| <b>CF03ARPR635</b>  | M 6 x 35                 | 5,56   |
| <b>CF03ARPR640</b>  | M 6 x 40                 | 6,40   |
| <b>CF03ARPR645</b>  | M 6 x 45                 | 7,20   |
| <b>CF03ARPR650</b>  | M 6 x 50                 | 9,36   |
| <b>CF03ARPR655</b>  | M 6 x 55                 | 10,26  |
| <b>CF03ARPR810</b>  | M 8 x 10                 | 3,31   |
| <b>CF03ARPR812</b>  | M 8 x 12                 | 4,30   |
| <b>CF03ARPR815</b>  | M 8 x 15                 | 4,90   |
| <b>CF03ARPR816</b>  | M 8 x 16                 | 5,82   |
| <b>CF03ARPR820</b>  | M 8 x 20                 | 6,50   |
| <b>CF03ARPR825</b>  | M 8 x 25                 | 8,13   |
| <b>CF03ARPR830</b>  | M 8 x 30                 | 9,80   |
| <b>CF03ARPR835</b>  | M 8 x 35                 | 11,40  |
| <b>CF03ARPR840</b>  | M 8 x 40                 | 13,05  |
| <b>CF03ARPR845</b>  | M 8 x 45                 | 14,70  |
| <b>CF03ARPR850</b>  | M 8 x 50                 | 16,35  |
| <b>CF03ARPR855</b>  | M 8 x 55                 | 22,90  |
| <b>CF03ARPR860</b>  | M 8 x 60                 | 24,90  |
| <b>CF03ARPR10</b>   | M 10 x Lungh./<br>Lengh. | Solo su richiesta<br>Only on demand            |

Prigionieri in Ottone CuZn37 su richiesta  
Studs in Brass (Ms63) on demand

- > Misure e materiali speciali su richiesta
- > On special request modified dimensions and materials can be supplied

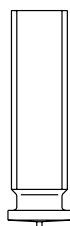

| CODICE<br>ORDER-NO. | Misura<br>Dimensions      | Peso<br>kg/1000 pezzi<br>Weight<br>kg/1000 pcs |
|---------------------|---------------------------|--|
| <b>CF03IXPRM2.5</b> | M 2,5 x Lungh./<br>Lengh. | Solo su richiesta<br>Only on demand            |
| <b>CF03IXPR306</b>  | M 3 x 6                   | 0,31   |
| <b>CF03IXPR308</b>  | M 3 x 8                   | 0,38   |
| <b>CF03IXPR310</b>  | M 3 x 10                  | 0,48   |
| <b>CF03IXPR312</b>  | M 3 x 12                  | 0,55   |
| <b>CF03IXPR315</b>  | M 3 x 15                  | 0,67   |
| <b>CF03IXPR316</b>  | M 3 x 16                  | 0,67   |
| <b>CF03IXPR320</b>  | M 3 x 20                  | 0,69   |
| <b>CF03IXPR325</b>  | M 3 x 25                  | 1,05   |
| <b>CF03IXPR330</b>  | M 3 x 30                  | 1,30   |
| <b>CF03IXPR335</b>  | M 3 x 35                  | 1,55   |
| <b>CF03IXPR340</b>  | M 3 x 40                  | 1,76   |
| <b>CF03IXPR406</b>  | M 4 x 6                   | 0,49   |
| <b>CF03IXPR408</b>  | M 4 x 8                   | 0,65   |
| <b>CF03IXPR410</b>  | M 4 x 10                  | 0,80   |
| <b>CF03IXPR412</b>  | M 4 x 12                  | 0,95   |
| <b>CF03IXPR415</b>  | M 4 x 15                  | 1,15   |
| <b>CF03IXPR416</b>  | M 4 x 16                  | 1,20   |
| <b>CF03IXPR420</b>  | M 4 x 20                  | 1,57   |
| <b>CF03IXPR425</b>  | M 4 x 25                  | 1,85   |
| <b>CF03IXPR430</b>  | M 4 x 30                  | 2,20   |
| <b>CF03IXPR435</b>  | M 4 x 35                  | 2,50   |
| <b>CF03IXPR440</b>  | M 4 x 40                  | 3,19   |
| <b>CF03IXPR445</b>  | M 4 x 45                  | 3,57   |
| <b>CF03IXPR508</b>  | M 5 x 8                   | 0,90   |
| <b>CF03IXPR510</b>  | M 5 x 10                  | 1,28   |
| <b>CF03IXPR512</b>  | M 5 x 12                  | 1,42   |
| <b>CF03IXPR515</b>  | M 5 x 15                  | 1,80   |
| <b>CF03IXPR516</b>  | M 5 x 16                  | 1,90   |
| <b>CF03IXPR520</b>  | M 5 x 20                  | 2,41   |
| <b>CF03IXPR525</b>  | M 5 x 25                  | 3,04   |
| <b>CF03IXPR530</b>  | M 5 x 30                  | 3,63   |
| <b>CF03IXPR535</b>  | M 5 x 35                  | 4,25   |
| <b>CF03IXPR540</b>  | M 5 x 40                  | 4,85   |
| <b>CF03IXPR545</b>  | M 5 x 45                  | 5,87   |
| <b>CF03IXPR550</b>  | M 5 x 50                  | 6,50   |

| CODICE<br>ORDER-NO. | Misura<br>Dimensions     | Peso<br>kg/1000 pezzi<br>Weight<br>kg/1000 pcs |
|---------------------|--------------------------|--|
| <b>CF03IXPR608</b>  | M 6 x 8                  | 1,50   |
| <b>CF03IXPR610</b>  | M 6 x 10                 | 1,87   |
| <b>CF03IXPR612</b>  | M 6 x 12                 | 2,25   |
| <b>CF03IXPR615</b>  | M 6 x 15                 | 2,65   |
| <b>CF03IXPR616</b>  | M 6 x 16                 | 2,70   |
| <b>CF03IXPR620</b>  | M 6 x 20                 | 3,55   |
| <b>CF03IXPR625</b>  | M 6 x 25                 | 4,40   |
| <b>CF03IXPR630</b>  | M 6 x 30                 | 5,25   |
| <b>CF03IXPR635</b>  | M 6 x 35                 | 6,05   |
| <b>CF03IXPR640</b>  | M 6 x 40                 | 6,96   |
| <b>CF03IXPR645</b>  | M 6 x 45                 | 7,80   |
| <b>CF03IXPR650</b>  | M 6 x 50                 | 9,36   |
| <b>CF03IXPR655</b>  | M 6 x 55                 | 10,26  |
| <b>CF03IXPR810</b>  | M 8 x 10                 | 3,33   |
| <b>CF03IXPR812</b>  | M 8 x 12                 | 3,96   |
| <b>CF03IXPR815</b>  | M 8 x 15                 | 4,90   |
| <b>CF03IXPR816</b>  | M 8 x 16                 | 5,82   |
| <b>CF03IXPR820</b>  | M 8 x 20                 | 6,50   |
| <b>CF03IXPR825</b>  | M 8 x 25                 | 8,00   |
| <b>CF03IXPR830</b>  | M 8 x 30                 | 9,60   |
| <b>CF03IXPR835</b>  | M 8 x 35                 | 11,20  |
| <b>CF03IXPR840</b>  | M 8 x 40                 | 12,70  |
| <b>CF03IXPR845</b>  | M 8 x 45                 | 14,20  |
| <b>CF03IXPR850</b>  | M 8 x 50                 | 15,80  |
| <b>CF03IXPR855</b>  | M 8 x 55                 | 22,90  |
| <b>CF03IXPR860</b>  | M 8 x 60                 | 24,90  |
| <b>CF03IXPR10</b>   | M 10 x Lungh./<br>Lengh. | Solo su richiesta<br>Only on demand            |

## INDICE/INDEX

- > Misure e materiali speciali su richiesta
- > *On special request modified dimensions and materials can be supplied*



| CODICE<br>ORDER-NO. | Misura<br>Dimensions | Peso<br>kg/1000 pezzi<br>Weight<br>kg/1000 pcs | CODICE<br>ORDER-NO. | Misura<br>Dimensions     | Peso<br>kg/1000 pezzi<br>Weight<br>kg/1000 pcs |
|---------------------|----------------------|--|---------------------|--------------------------|--|
| CF03ALPR306         | M 3 x 6              | 0,10   | CF03ALPR608         | M 6 x 8                  | 0,46   |
| CF03ALPR308         | M 3 x 8              | 0,13   | CF03ALPR610         | M 6 x 10                 | 0,55   |
| CF03ALPR310         | M 3 x 10             | 0,14   | CF03ALPR612         | M 6 x 12                 | 0,70   |
| CF03ALPR312         | M 3 x 12             | 0,15   | CF03ALPR615         | M 6 x 15                 | 0,85   |
| CF03ALPR315         | M 3 x 15             | 0,21   | CF03ALPR616         | M 6 x 16                 | 0,90   |
| CF03ALPR316         | M 3 x 16             | 0,23   | CF03ALPR620         | M 6 x 20                 | 1,19   |
| CF03ALPR320         | M 3 x 20             | 0,29   | CF03ALPR625         | M 6 x 25                 | 1,41   |
| CF03ALPR325         | M 3 x 25             | 0,39   | CF03ALPR630         | M 6 x 30                 | 2,34   |
| CF03ALPR330         | M 3 x 30             | 0,49   | CF03ALPR635         | M 6 x 35                 | 2,60   |
| CF03ALPR406         | M 4 x 6              | 0,15   | CF03ALPR640         | M 6 x 40                 | 6,96   |
| CF03ALPR408         | M 4 x 8              | 0,18   | CF03ALPR810         | M 8 x 10                 | 1,13   |
| CF03ALPR410         | M 4 x 10             | 0,27   | CF03ALPR812         | M 8 x 12                 | 1,35   |
| CF03ALPR412         | M 4 x 12             | 0,32   | CF03ALPR815         | M 8 x 15                 | 1,60   |
| CF03ALPR415         | M 4 x 15             | 0,39   | CF03ALPR816         | M 8 x 16                 | 1,75   |
| CF03ALPR416         | M 4 x 16             | 0,39   | CF03ALPR820         | M 8 x 20                 | 2,15   |
| CF03ALPR420         | M 4 x 20             | 0,50   | CF03ALPR825         | M 8 x 25                 | 2,65   |
| CF03ALPR425         | M 4 x 25             | 0,65   | CF03ALPR830         | M 8 x 30                 | 3,24   |
| CF03ALPR430         | M 4 x 30             | 0,76   | CF03ALPR10          | M 10 x Lungh./<br>Lengh. | Solo su richiesta<br>Only on demand            |
| CF03ALPR435         | M 4 x 35             | 0,92   |                     |                          |  |
| CF03ALPR508         | M 5 x 8              | 0,34   |                     |                          |  |
| CF03ALPR510         | M 5 x 10             | 0,40   |                     |                          |  |
| CF03ALPR512         | M 5 x 12             | 0,50   |                     |                          |  |
| CF03ALPR515         | M 5 x 15             | 0,62   |                     |                          |  |
| CF03ALPR516         | M 5 x 16             | 0,64   |                     |                          |  |
| CF03ALPR520         | M 5 x 20             | 0,88   |                     |                          |  |
| CF03ALPR525         | M 5 x 25             | 1,00   |                     |                          |  |
| CF03ALPR530         | M 5 x 30             | 1,25   |                     |                          |  |
| CF03ALPR535         | M 5 x 35             | 1,42   |                     |                          |  |
| CF03ALPR540         | M 5 x 40             | 1,65   |                     |                          |  |

## INDICE/INDEX

- > Misure e materiali speciali su richiesta
- > On special request modified dimensions and materials can be supplied



| CODICE<br>ORDER-NO. | Misura<br>Dimensions      | Peso<br>kg/1000 pezzi<br>Weight<br>kg/1000 pcs |
|---------------------|---------------------------|--|
|                     | S 2,1 x Lungh./<br>Lengh. | Solo su richiesta<br>Only on demand            |
|                     | S 2,6 x Lungh./<br>Lengh. |  |
| CF03ARPL306         | S 3 x 6                   | 0,33   |
| CF03ARPL308         | S 3 x 8                   | 0,42   |
| CF03ARPL310         | S 3 x 10                  | 0,49   |
| CF03ARPL312         | S 3 x 12                  | 0,54   |
| CF03ARPL315         | S 3 x 15                  | 0,64   |
| CF03ARPL320         | S 3 x 20                  | 0,82   |
| CF03ARPL325         | S 3 x 25                  | 0,98   |
| CF03ARPL406         | S 4 x 6                   | 0,60   |
| CF03ARPL408         | S 4 x 8                   | 0,67   |
| CF03ARPL410         | S 4 x 10                  | 0,80   |
| CF03ARPL412         | S 4 x 12                  | 0,95   |
| CF03ARPL415         | S 4 x 15                  | 1,18   |
| CF03ARPL416         | S 4 x 16                  | 1,18   |
| CF03ARPL420         | S 4 x 20                  | 1,54   |
| CF03ARPL425         | S 4 x 25                  | 1,92   |
| CF03ARPL430         | S 4 x 30                  | 2,30   |
| CF03ARPL435         | S 4 x 35                  | 2,65   |
| CF03ARPL508         | S 5 x 8                   | 1,15   |
| CF03ARPL510         | S 5 x 10                  | 1,35   |
| CF03ARPL512         | S 5 x 12                  | 1,60   |
| CF03ARPL515         | S 5 x 15                  | 1,95   |
| CF03ARPL520         | S 5 x 20                  | 2,55   |
| CF03ARPL525         | S 5 x 25                  | 3,15   |
| CF03ARPL530         | S 5 x 30                  | 3,75   |
| CF03ARPL535         | S 5 x 35                  | 4,35   |
| CF03ARPL540         | S 5 x 40                  | 4,92   |

| CODICE<br>ORDER-NO. | Misura<br>Dimensions | Peso<br>kg/1000 pezzi<br>Weight<br>kg/1000 pcs |
|---------------------|----------------------|--|
| CF03ARPL608         | S 6 x 8              | 1,65   |
| CF03ARPL610         | S 6 x 10             | 1,85   |
| CF03ARPL612         | S 6 x 12             | 2,10   |
| CF03ARPL615         | S 6 x 15             | 2,68   |
| CF03ARPL620         | S 6 x 20             | 3,40   |
| CF03ARPL625         | S 6 x 25             | 4,15   |
| CF03ARPL630         | S 6 x 30             | 4,90   |
| CF03ARPL635         | S 6 x 35             | 5,65   |
| CF03ARPL640         | S 6 x 40             | 6,40   |
| CF03ARPL645         | S 6 x 35             | 7,20   |
| CF03ARPL7,110       | S 7,1 x 10           | 3,31   |
| CF03ARPL7,112       | S 7,1 x 12           | 4,00   |
| CF03ARPL7,115       | S 7,1 x 15           | 4,90   |
| CF03ARPL7,120       | S 7,1 x 20           | 6,50   |
| CF03ARPL7,125       | S 7,1 x 25           | 8,13   |
| CF03ARPL7,130       | S 7,1 x 30           | 9,80   |

S 8 x Lungh./Lengh. Solo su richiesta  
Only on demand

Prigionieri in Ottone CuZn37 su richiesta  
Studs in Brass (Ms63) on demand

## INDICE/INDEX

- > Misure e materiali speciali su richiesta
- > On special request modified dimensions and materials can be supplied



| CODICE<br>ORDER-NO. | Misura<br>Dimensions      | Peso<br>kg/1000 pezzi<br>Weight<br>kg/1000 pcs |
|---------------------|---------------------------|--|
|                     | S 2,1 x Lungh./<br>Lengh. | Solo su richiesta<br>Only on demand            |
|                     | S 2,6 x Lungh./<br>Lengh. |  |
| CF03IXPL306         | S 3 x 6                   | 0,31   |
| CF03IXPL308         | S 3 x 8                   | 0,38   |
| CF03IXPL310         | S 3 x 10                  | 0,48   |
| CF03IXPL312         | S 3 x 12                  | 0,55   |
| CF03IXPL315         | S 3 x 15                  | 0,67   |
| CF03IXPL316         | S 3 x 16                  | 0,67   |
| CF03IXPL320         | S 3 x 20                  | 0,89   |
| CF03IXPL325         | S 3 x 25                  | 1,05   |
| CF03IXPL406         | S 4 x 6                   | 0,50   |
| CF03IXPL408         | S 4 x 8                   | 0,65   |
| CF03IXPL410         | S 4 x 10                  | 0,80   |
| CF03IXPL412         | S 4 x 12                  | 0,95   |
| CF03IXPL415         | S 4 x 15                  | 1,15   |
| CF03IXPL416         | S 4 x 16                  | 1,20   |
| CF03IXPL420         | S 4 x 20                  | 1,57   |
| CF03IXPL425         | S 4 x 25                  | 1,85   |
| CF03IXPL430         | S 4 x 30                  | 2,20   |
| CF03IXPL435         | S 4 x 35                  | 2,50   |
| CF03IXPL508         | S 5 x 8                   | 0,90   |
| CF03IXPL510         | S 5 x 10                  | 1,28   |
| CF03IXPL512         | S 5 x 12                  | 1,42   |
| CF03IXPL515         | S 5 x 15                  | 1,80   |
| CF03IXPL516         | S 5 x 16                  | 1,80   |
| CF03IXPL520         | S 5 x 20                  | 2,41   |
| CF03IXPL525         | S 5 x 25                  | 3,04   |
| CF03IXPL530         | S 5 x 30                  | 3,63   |
| CF03IXPL535         | S 5 x 35                  | 4,25   |
| CF03IXPL540         | S 5 x 40                  | 4,85   |

| CODICE<br>ORDER-NO. | Misura<br>Dimensions | Peso<br>kg/1000 pezzi<br>Weight<br>kg/1000 pcs |
|---------------------|----------------------|--|
| CF03IXPL608         | S 6 x 8              | 1,40   |
| CF03IXPL610         | S 6 x 10             | 1,86   |
| CF03IXPL612         | S 6 x 12             | 2,25   |
| CF03IXPL615         | S 6 x 15             | 2,65   |
| CF03IXPL616         | S 6 x 16             | 2,66   |
| CF03IXPL620         | S 6 x 20             | 3,55   |
| CF03IXPL625         | S 6 x 25             | 4,40   |
| CF03IXPL630         | S 6 x 30             | 5,25   |
| CF03IXPL635         | S 6 x 35             | 6,05   |
| CF03IXPL640         | S 6 x 40             | 6,96   |
| CF03IXPL645         | S 6 x 35             | 7,80   |
| CF03IXPL7,110       | S 7,1 x 10           | 3,33   |
| CF03IXPL7,112       | S 7,1 x 12           | 3,90   |
| CF03IXPL7,115       | S 7,1 x 15           | 4,90   |
| CF03IXPL7,116       | S 7,1 x 16           | 5,80   |
| CF03IXPL7,120       | S 7,1 x 20           | 6,50   |
| CF03IXPL7,125       | S 7,1 x 25           | 8,00   |
| CF03IXPL7,130       | S 7,1 x 30           | 9,60   |
| CF03IXPL7,135       | S 7,1 x 35           | 11,20  |
| CF03IXPL7,140       | S 7,1 x 40           | 12,70  |
| CF03IXPL7,145       | S 7,1 x 45           | 14,20  |
| CF03IXPL7,150       | S 7,1 x 50           | 15,80  |

S 8 x Lungh./Lengh. Solo su richiesta  
Only on demand

## INDICE/INDEX

- > Misure e materiali speciali su richiesta
- > On special request modified dimensions and materials can be supplied



| CODICE<br>ORDER-NO. | Misura<br>Dimensions      | Peso<br>kg/1000 pezzi<br>Weight<br>kg/1000 pcs |
|---------------------|---------------------------|--|
|                     | S 2,1 x Lungh./<br>Lengh. | Solo su richiesta<br>Only on demand            |
|                     | S 2,6 x Lungh./<br>Lengh. |  |
| CF03ALPL306         | S 3 x 6                   | 0,14   |
| CF03ALPL308         | S 3 x 8                   | 0,18   |
| CF03ALPL310         | S 3 x 10                  | 0,22   |
| CF03ALPL312         | S 3 x 12                  | 0,25   |
| CF03ALPL315         | S 3 x 15                  | 0,31   |
| CF03ALPL320         | S 3 x 20                  | 0,40   |
| CF03ALPL325         | S 3 x 25                  | 0,50   |
| CF03ALPL406         | S 4 x 6                   | 0,26   |
| CF03ALPL408         | S 4 x 8                   | 0,32   |
| CF03ALPL410         | S 4 x 10                  | 0,39   |
| CF03ALPL412         | S 4 x 12                  | 0,45   |
| CF03ALPL415         | S 4 x 15                  | 0,55   |
| CF03ALPL420         | S 4 x 20                  | 0,72   |
| CF03ALPL425         | S 4 x 25                  | 0,89   |
| CF03ALPL430         | S 4 x 30                  | 1,05   |
| CF03ALPL435         | S 4 x 35                  | 1,22   |
| CF03ALPL508         | S 5 x 8                   | 0,34   |
| CF03ALPL510         | S 5 x 10                  | 0,40   |
| CF03ALPL512         | S 5 x 12                  | 0,50   |
| CF03ALPL515         | S 5 x 15                  | 0,62   |
| CF03ALPL520         | S 5 x 20                  | 0,88   |
| CF03ALPL525         | S 5 x 25                  | 1,00   |
| CF03ALPL530         | S 5 x 30                  | 1,24   |
| CF03ALPL535         | S 5 x 35                  | 1,42   |
| CF03ALPL540         | S 5 x 40                  | 1,65   |

| CODICE<br>ORDER-NO. | Misura<br>Dimensions | Peso<br>kg/1000 pezzi<br>Weight<br>kg/1000 pcs |
|---------------------|----------------------|--|
| CF03ALPL608         | S 6 x 8              | 0,40   |
| CF03ALPL610         | S 6 x 10             | 0,55   |
| CF03ALPL612         | S 6 x 12             | 0,70   |
| CF03ALPL615         | S 6 x 15             | 0,85   |
| CF03ALPL620         | S 6 x 20             | 1,19   |
| CF03ALPL625         | S 6 x 25             | 1,41   |
| CF03ALPL630         | S 6 x 30             | 1,70   |
| CF03ALPL635         | S 6 x 35             | 1,98   |
| CF03ALPL640         | S 6 x 40             | 2,34   |
| CF03ALPL645         | S 6 x 35             | 2,60   |
| CF03ALPL7,110       | S 7,1 x 10           | 1,30   |
| CF03ALPL7,112       | S 7,1 x 12           | 1,42   |
| CF03ALPL7,1-15      | S 7,1 x 15           | 1,60   |
| CF03ALPL7,120       | S 7,1 x 20           | 2,15   |
| CF03ALPL7,125       | S 7,1 x 25           | 2,65   |
| CF03ALPL7,130       | S 7,1 x 30           | 3,24   |
|                     | S 8 x Lungh./Lengh.  | Solo su richiesta<br>Only on demand            |

## INDICE/INDEX

- > Misure e materiali speciali su richiesta
- > On special request modified dimensions and materials can be supplied

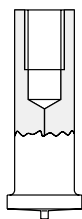

| CODICE<br>ORDER-NO. | Misura<br>Dimensions | Peso<br>kg/1000 pezzi<br>Weight<br>kg/1000 pcs |
|---------------------|----------------------|--|
| CF03ARBU3506        | 5 M 3 x 6            | 0,70   |
| CF03ARBU3508        | 5 M 3 x 8            | 0,89   |
| CF03ARBU3510        | 5 M 3 x 10           | 1,13   |
| CF03ARBU3512        | 5 M 3 x 12           | 1,37   |
| CF03ARBU3515        | 5 M 3 x 15           | 1,72   |
| CF03ARBU3516        | 5 M 3 x 16           | 1,72   |
| CF03ARBU3520        | 5 M 3 x 20           | 2,32   |
| CF03ARBU3525        | 5 M 3 x 25           | 2,91   |
| CF03ARBU3530        | 5 M 3 x 30           | 3,50   |
| CF03ARBU4606        | 6 M 4 x 6            | 2,03   |
| CF03ARBU4608        | 6 M 4 x 8            | 2,07   |
| CF03ARBU4610        | 6 M 4 x 10           | 2,51   |
| CF03ARBU4612        | 6 M 4 x 12           | 3,18   |
| CF03ARBU4615        | 6 M 4 x 15           | 3,30   |
| CF03ARBU4620        | 6 M 4 x 20           | 4,28   |
| CF03ARBU4625        | 6 M 4 x 25           | 5,39   |
| CF03ARBU4630        | 6 M 4 x 30           | 6,40   |
| CF03ARBU5708        | 7,1 M 5 x 8          | 3,30   |
| CF03ARBU5710        | 7,1 M 5 x 10         | 3,30   |
| CF03ARBU5712        | 7,1 M 5 x 12         | 3,90   |
| CF03ARBU5715        | 7,1 M 5 x 15         | 5,20   |
| CF03ARBU5716        | 7,1 M 5 x 16         | 5,20   |
| CF03ARBU5718        | 7,1 M 5 x 18         | 6,00   |
| CF03ARBU5720        | 7,1 M 5 x 20         | 6,50   |
| CF03ARBU5725        | 7,1 M 5 x 25         | 8,10   |
| CF03ARBU5730        | 7,1 M 5 x 30         | 9,80   |
| CF03ARBU6810        | 8 M 6 x 10           | 3,63   |
| CF03ARBU6812        | 8 M 6 x 12           | 4,29   |
| CF03ARBU6815        | 8 M 6 x 15           | 5,72   |
| CF03ARBU6820        | 8 M 6 x 20           | 7,15   |
| CF03ARBU6825        | 8 M 6 x 25           | 8,91   |
| CF03ARBU6830        | 8 M 6 x 30           | 10,78  |

Bussole in Ottone CuZn37 su richiesta  
Tapped Studs in Brass (Ms63) on demand

- > Misure e materiali speciali su richiesta
- > On special request modified dimensions and materials can be supplied

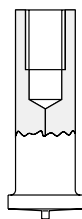

| CODICE<br>ORDER-NO. | Misura<br>Dimensions | Peso<br>kg/1000 pezzi<br>Weight<br>kg/1000 pcs |
|---------------------|----------------------|--|
| CF03IXBU3506        | 5 M 3 x 6            | 0,89   |
| CF03IXBU3508        | 5 M 3 x 8            | 0,89   |
| CF03IXBU3510        | 5 M 3 x 10           | 1,13   |
| CF03IXBU3512        | 5 M 3 x 12           | 1,37   |
| CF03IXBU3515        | 5 M 3 x 15           | 1,72   |
| CF03IXBU3516        | 5 M 3 x 16           | 1,72   |
| CF03IXBU3520        | 5 M 3 x 20           | 2,32   |
| CF03IXBU3525        | 5 M 3 x 25           | 2,91   |
| CF03IXBU3530        | 5 M 3 x 30           | 3,50   |
| CF03IXBU4606        | 6 M 4 x 6            | 2,03   |
| CF03IXBU4608        | 6 M 4 x 8            | 2,07   |
| CF03IXBU4610        | 6 M 4 x 10           | 2,51   |
| CF03IXBU4612        | 6 M 4 x 12           | 3,18   |
| CF03IXBU4615        | 6 M 4 x 15           | 3,30   |
| CF03IXBU4620        | 6 M 4 x 20           | 4,28   |
| CF03IXBU4625        | 6 M 4 x 25           | 5,39   |
| CF03IXBU4630        | 6 M 4 x 30           | 6,40   |
| CF03IXBU5710        | 7,1 M 5 x 10         | 3,30   |
| CF03IXBU5712        | 7,1 M 5 x 12         | 3,90   |
| CF03IXBU5715        | 7,1 M 5 x 15         | 5,20   |
| CF03IXBU5716        | 7,1 M 5 x 16         | 5,20   |
| CF03IXBU5720        | 7,1 M 5 x 20         | 6,50   |
| CF03IXBU5725        | 7,1 M 5 x 25         | 8,10   |
| CF03IXBU5730        | 7,1 M 5 x 30         | 9,80   |
| CF03IXBU6810        | 8 M 6 x 10           | 3,63   |
| CF03IXBU6812        | 8 M 6 x 12           | 4,29   |
| CF03IXBU6815        | 8 M 6 x 15           | 5,72   |
| CF03IXBU6820        | 8 M 6 x 20           | 7,15   |
| CF03IXBU6825        | 8 M 6 x 25           | 8,91   |
| CF03IXBU6830        | 8 M 6 x 30           | 10,78  |

## INDICE/INDEX

- > Misure e materiali speciali su richiesta
- > *On special request modified dimensions and materials can be supplied*

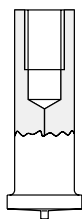

| CODICE<br>ORDER-NO. | Misura<br>Dimensions      | Peso<br>kg/1000 pezzi<br>Weight<br>kg/1000 pcs |
|---------------------|---------------------------|--|
| CF03ALBU3506        | 5 M 3 x 6                 | 0,49   |
| CF03ALBU3508        | 5 M 3 x 8                 | 0,59   |
| CF03ALBU3510        | 5 M 3 x 10                | 0,70   |
| CF03ALBU3512        | 5 M 3 x 12                | 0,80   |
| CF03ALBU3515        | 5 M 3 x 15                | 1,00   |
| CF03ALBU3516        | 5 M 3 x 16                | 1,01   |
| CF03ALBU3520        | 5 M 3 x 20                | 1,23   |
| CF03ALBU3525        | 5 M 3 x 25                | 1,49   |
| CF03ALBU3530        | 5 M 3 x 30                | 1,76   |
| CF03ALBU4608        | 6 M 4 x 8                 | 0,30   |
| CF03ALBU4610        | 6 M 4 x 10                | 0,60   |
| CF03ALBU4612        | 6 M 4 x 12                | 0,90   |
| CF03ALBU4615        | 6 M 4 x 15                | 1,46   |
| CF03ALBU4620        | 6 M 4 x 20                | 1,77   |
| CF03ALBU4625        | 6 M 4 x 25                | 2,16   |
| CF03ALBU4630        | 6 M 4 x 30                | 2,55   |
| CF03ALBU5710        | 7,1 M 5 x 10              | 1,42   |
| CF03ALBU5712        | 7,1 M 5 x 12              | 1,64   |
| CF03ALBU5715        | 7,1 M 5 x 15              | 2,07   |
| CF03ALBU5720        | 7,1 M 5 x 20              | 2,51   |
| CF03ALBU5725        | 7,1 M 5 x 25              | 3,08   |
| CF03ALBU5730        | 7,1 M 5 x 30              | 3,63   |
|                     | 8 M 6 x Lungh./<br>Lengh. | Solo su richiesta<br>Only on demand            |

## INDICE/INDEX

- > Misure e materiali speciali su richiesta
- > On special request modified dimensions and materials can be supplied

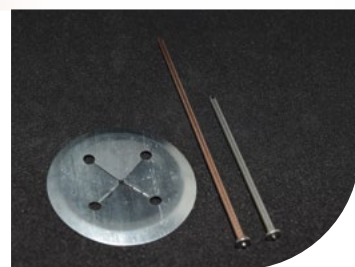
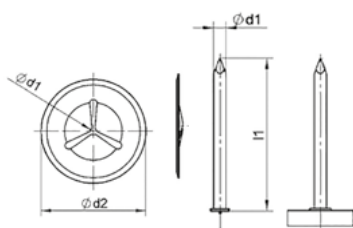

| CODICE<br>ORDER-NO.  | Misura<br>Dimensions | Peso<br>kg/1000 pezzi<br>Weight<br>kg/1000 pcs |
|----------------------|----------------------|--|
| <b>CF03CHR2020</b>   | 2 x 20 Ferro Ramato  | 0,50   |
| <b>CF03CHR2030</b>   | 2 x 30 Ferro Ramato  | 0,77   |
| <b>CF03CHR2040</b>   | 2 x 40 Ferro Ramato  | 1,04   |
| <b>CF03CHR2050</b>   | 2 x 50 Ferro Ramato  | 1,31   |
| <b>CF03CHR2060</b>   | 2 x 60 Ferro Ramato  | 1,59   |
| <b>CF03CHR2070</b>   | 2 x 70 Ferro Ramato  | 1,86   |
| <b>CF03CHR2085</b>   | 2 x 85 Ferro Ramato  | 2,25   |
| <b>CF03CHR2100</b>   | 2 x 100 Ferro Ramato | 2,67   |
| <b>CF03CHR3020</b>   | 3 x 20 Ferro Ramato  | 1,04   |
| <b>CF03CHR3050</b>   | 3 x 50 Ferro Ramato  | 2,70   |
| <b>CF03CHR3065</b>   | 3 x 65 Ferro Ramato  | 3,50   |
| <b>CF03CHR3085</b>   | 3 x 85 Ferro Ramato  | 4,36   |
| <b>CF03CHR3100</b>   | 3 x 100 Ferro Ramato | 5,47   |
| <b>CF03CHR3150</b>   | 3 x 150 Ferro Ramato | 8,17   |
| <b>CF03IXCHR2030</b> | 2 x 30 Inox          | 0,78   |
| <b>CF03IXCHR2050</b> | 2 x 50 Inox          | 1,32   |
| <b>CF03IXCHR2065</b> | 2 x 65 Inox          | 1,60   |
| <b>CF03IXCHR2085</b> | 2 x 85 Inox          | 2,14   |
| <b>CF03IXCHR2100</b> | 2 x 100 Inox         | 2,69   |
| <b>CF03CHR2038</b>   | Clip R2x38 Ferro Zn  | 4,40   |
| <b>CF03CHR3038</b>   | Clip R3x38 Ferro Zn  | 4,40   |
| <b>CF03CHR4038</b>   | Clip R4x38 Ferro Zn  | 4,40   |
| <b>CF03CHR5038</b>   | Clip R5x38 Ferro Zn  | 4,40   |
| <b>CF03CHR6038</b>   | Clip R6x38 Ferro Zn  | 4,40   |
| <b>CF03IXCHR2038</b> | Clip R2x38 Inox      | 4,40   |
| <b>CF03IXCHR3038</b> | Clip R3x38 Inox      | 4,40   |

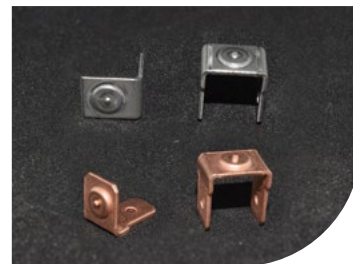

> Misure e materiali speciali su richiesta  
 > *On special request modified dimensions and materials can be supplied*

| CODICE / ORDER-NO. |                 | Misura<br>Dimensions | Peso<br>kg/1000 pezzi<br>Weight<br>kg/1000 pcs |
|--------------------|-----------------|----------------------|--|
| F1 SEMPLICI        | F2 DOPPI        |                      |  |
| <b>CF03ARFS</b>    | <b>CF03ARFD</b> | 6,3 Ferro ramato     | 0,98   |
| <b>CF03IXFS</b>    | <b>CF03IXFD</b> | 6,3 Inox             | 1,00   |
| <b>CF03CUFS</b>    | <b>CF03CUFD</b> | 6,3 Ottone           | 0,98   |
| <b>CF03ALFD</b>    | <b>CF03ALFD</b> | 6,3 Alluminio        | 0,50   |

Prima  
della saldatura

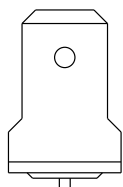

Dopo  
della saldatura

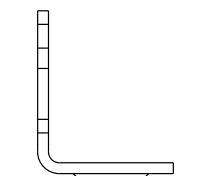

FASTON **F1** SEMPLICI

Prima  
della saldatura

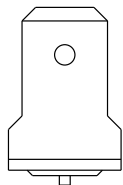

Dopo  
della saldatura

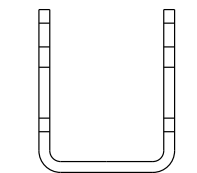

FASTON **F2** DOPPI

# PRIGIONIERI PER ARCO CORTO

CFPD

**CARUSO**  
FASTENERS

FERRO RAMATO 4.8 - ACCIAIO INOX (1.4301/3) /  
ST 37 COPPER PLATED - (A2-50) STAINLESS STEEL

## INDICE/INDEX

| D1  | D3   | H       | L       |
|-----|------|---------|---------|
| M5  | 6,0  |         |         |
| M6  | 7,0  |         |         |
| M8  | 9,0  | 0,8-1,4 | 8-50 MM |
| M10 | 11,0 |         |         |
| M12 | 13,0 |         |         |

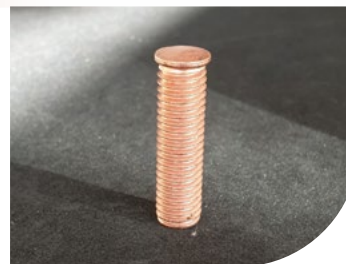

ESEMPIO CODIFICA ARTICOLO  
EXAMPLE CODING ARTICLE

RAMATO CFPSCRM615

INOX CFPSCM615

## PRIGIONIERI CHRISTMAS CFPD / CFSC

FERRO RAMATO 4.8 / ST 37 COPPER PLATED

### CHRISTMAS TREE STUDS CD

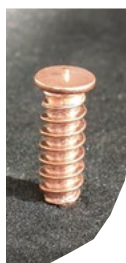
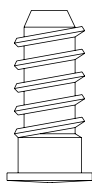

| CODICE<br>ORDER-NO. | Misura d x l<br>Dimensions |
|---------------------|----------------------------|
| CF11-005-S009       | Ø 5 x 9                    |
| CF11-005-S014       | Ø 5 x 14,2                 |
| CF11-005-S018       | Ø 5 x 18                   |
| CF11-005-S025       | Ø 5 x 25                   |

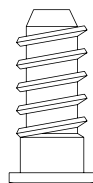

### CHRISTMAS TREE STUDS SC

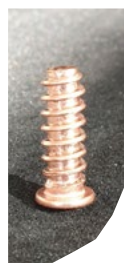

| CODICE<br>ORDER-NO. | Misura d x l<br>Dimensions |
|---------------------|----------------------------|
| CF11-055-S009       | Ø 5 x 9                    |
| CF11-055-S012       | Ø 5 x 12                   |
| CF11-055-S014       | Ø 5 x 14,2                 |
| CF11-055-S018       | Ø 5 x 18                   |
| CF11-055-S025       | Ø 5 x 25                   |

## PRIGIONIERI AUTOPULENTI

FERRO RAMATO 4.8 / ST 37 COPPER PLATED

### COLOUR GRAVE STUDS

| CODICE<br>ORDER-NO. |         |
|---------------------|---------|
| CFPSRAUT            | M6 x 12 |
|                     | M6 x 15 |
|                     | M6 x 20 |

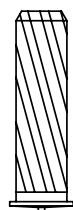







# DA 30 ANNI AL FIANCO DI CHI USA FASTENERS



Via delle Gallarane, 10/12 | 22046 Merone (CO)

Tel. 031 3333486 | Fax 031 3339064

C.F. | P.IVA 03228940130

[www.carusofasteners.it](http://www.carusofasteners.it) | [info@carusofasteners.it](mailto:info@carusofasteners.it)

