

CATALOGO CF 02
INSERTI FILETTATI



INDICE

**VISUALIZZA IL PRODOTTO CLICCANDO SU TIPOLOGIA O PAGINA
PER TORNARE ALL'INDICE, CLICCARE IL PULSANTE "INDICE"**

VIEW THE PRODUCT BY CLICKING ON TYPE OR PAGE.

RETURN TO THE INDEX BY CLICKING THE "INDEX" BUTTON

	CFACITT - TESTA TONDA CORPO CILINDRICO LISCIO 7 FLAT HEAD ROUND BODY PLAIN
	CFACITR - TESTA RIDOTTA CORPO CILINDRICO LISCIO 7 REDUCED HEAD ROUND BODY PLAIN
	CFACITTG - TESTA TONDA CORPO CILINDRICO ZIGRINATO 8 HEAD KNURLED BODY
	CFACITTCG - TESTA TONDA CORPO CILINDRICO ZIGRINATO CHIUSO FLAT HEAD KNURLED BODY CLOSE END
	CFACITRG - TESTA RIDOTTA CORPO CILINDRICO ZIGRINATO 9 REDUCED HEAD KNURLED BODY
	CFACITRCG - TESTA RIDOTTA CORPO CILINDRICO ZIGRINATO CHIUSO REDUCED HEAD KNURLED BODY CLOSE END
	CFACITS - TESTA SVASATA CORPO CILINDRICO LISCIO 10 COUNTERSUNK HEAD ROUND BODY PLAIN
	CFACITSG - TESTA SVASATA CORPO CILINDRICO ZIGRINATO 10 COUNTERSUNK HEAD KNURLED BODY
	CFACITSCG - TESTA SVASATA CORPO CILINDRICO ZIGRINATO CHIUSO 11 COUNTERSUNK HEAD KNURLED BODY CLOSE END
	CFACITTSE - TESTA TONDA CORPO SEMI ESAGONALE 11 FLAT HEAD SEMI-HEX BODY
	CFACITTE - TESTA TONDA CORPO ESAGONALE 12 FLAT HEAD FULL HEX BODY
	CFACITTEC - TESTA TONDA CORPO ESAGONALE CHIUSO FLAT HEAD FULL HEX BODY CLOSE END
	CFACIER - TESTA RIDOTTA CORPO ESAGONALE 13 REDUCED HEX HEAD FULL-HEX BODY
	CFACIERC - TESTA RIDOTTA CORPO ESAGONALE CHIUSO REDUCED HEX HEAD FULL-HEX BODY CLOSE END
	CFACIERSE - TESTA RIDOTTA CORPO SEMI-ESAGONALE 14 REDUCED HEX HEAD INNER-HEX BODY
	CFACITTSE - TESTA TONDA CORPO SEMI-ESAGONALE 14 FLAT HEAD INNER-HEX BODY
	CFACITRG - TESTA RIDOTTA CORPO CILINDRICO ZIGRINATO FILETTO IN POLLICI 15 REDUCED HEAD KNURLED BODY



CFACIERSE - TESTA RIDOTTA CORPO SEMI-ESAGONALE FILETTO IN POLLICI 15
REDUCED HEX HEAD INNER-HEX BODY-UK



CFIXITT - TESTA TONDA CORPO CILINDRICO LISCIO IN ACCIAIO INOX 16
FLAT HEAD ROUND BODY PLAIN STAINLESS STEEL



CFIXITR - TESTA RIDOTTA CORPO CILINDRICO LISCIO IN ACCIAIO INOX 16
REDUCE HEAD ROUND BODY PLAIN STAINLESS STEEL



CFIXITTG - TESTA TONDA CORPO CILINDRICO ZIGRINATO IN ACCIAIO INOX 17
FLAT HEAD KNURLED BODY STAINLESS STEEL

CFIXITTCG - TESTA TONDA CORPO CILINDRICO ZIGRINATO CHIUSO ACCIAIO INOX
FLAT HEAD KNURLED BODY CLOSE END STAINLESS STEEL



CFIXITRG - TESTA RIDOTTA CORPO CILINDRICO ZIGRINATO IN ACCIAIO INOX 18
REDUCE HEAD KNURLED BODY STAINLESS STEEL

CFIXITRCG - TESTA RIDOTTA CORPO CILINDRICO ZIGRINATO CHIUSO IN ACCIAIO INOX
REDUCE HEAD KNURLED BODY CLOSE END STAINLESS STEEL



CFIXITS - TESTA SVASATA CORPO CILINDRICO LISCIO IN ACCIAIO INOX 19
COUNTERSUNK HEAD ROUND BODY PLAIN STAINLESS STEEL



CFIXITSG - TESTA SVASATA CORPO CILINDRICO ZIGRINATO IN ACCIAIO INOX 20
COUNTERSUNK HEAD KNURLED BODY STAINLESS STEEL

CFIXITSCG - TESTA SVASATA CORPO CILINDRICO ZIGRINATO CIECO IN ACCIAIO INOX
COUNTERSUNK HEAD KNURLED BODY CLOSE END STAINLESS STEEL



CFIXIERSE - TESTA RIDOTTA CORPO SEMI-ESAGONALE IN ACCIAIO INOX 21
REDUCE HEX HEAD INNER-HEX BODY STAINLESS STEEL

CFIXIERSEC - TESTA RIDOTTA CORPO SEMI-ESAGONALE IN ACCIAIO INOX CHIUSI
REDUCE HEAD INNER-HEX BODY CLOSE END STAINLESS STEEL



CFIXITTSE - TESTA TONDA CORPO SEMI-ESAGONALE IN ACCIAIO INOX 22
FLAT HEAD INNER-HEX BODY STAINLESS STEEL

CFIXITTSEC - TESTA TONDA CORPO SEMI-ESAGONALE CHIUSO ACCIAIO INOX
FLAT HEAD INNER-HEX BODY CLOSE END STAINLESS STEEL



CFALITT - TESTA TONDA CORPO CILINDRICO LISCIO ALLUMINIO 23
FLAT HEAD ROUND BODY PLAIN ALUMINIUM

CFALITR - TESTA RIDOTTA CORPO CILINDRICO LISCIO ALLUMINIO
REDUCED HEAD ROUND BODY PLAIN ALUMINIUM



CFALITTG - TESTA TONDA CORPO CILINDRICO ZIGRINATO ALLUMINIO 24
FLAT HEAD KNURLED BODY ALUMINIUM

CFALITRG - TESTA RIDOTTA CORPO CILINDRICO ZIGRINATO ALLUMINIO
REDUCED HEAD KNURLED BODY ALUMINIUM

INFORMAZIONI TECNICHE

TECHNICAL INFORMATION

COPPIA DI SERRAGGIO MASSIMA (Nm) MAX TIGHTENING TORQUE (Nm)

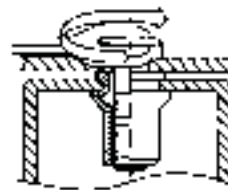

MATERIALE MATERIAL	TESTA HEAD	CORPO BODY	MISURA FILETTO THREAD SIZE						
			M3	M4	M5	M6	M8	M10	M12
FERRO C4C STEEL	TONDA FLAT	CILINDRICO E ESAGONALE ROUND AND HEXAGONAL	2	5	8,5	15	26	50	80
	SVASATA COUNTERSUNK	CILINDRICO ROUND	1	4	8	15	26	45	70
	RIDOTTA REDUCED	CILINDRICO E ESAGONALE ROUND AND HEXAGONAL	1	3	6	11	20	32	50
INOX (ANSI 304) STAINLESS STEEL	TONDA FLAT	CILINDRICO E ESAGONALE ROUND AND HEXAGONAL	2	5	8,5	15	26	50	80
	SVASATA COUNTERSUNK	CILINDRICO ROUND	1	4	8	15	26	45	70
	RIDOTTA REDUCED	CILINDRICO E ESAGONALE ROUND AND HEXAGONAL	1	3	6	11	20	32	50
ALLUMINIO Almg 2,5 ALUMINIUM	TONDA FLAT	CILINDRICO ROUND	0,7	2,5	5	8	20	25	-
	SVASATA COUNTERSUNK		0,7	2,5	5	8	20	25	-
	RIDOTTA REDUCED		0,7	2,5	5	8	20	25	-

CARICO DI TRAZIONE SUL FILETTO (N) PULL-OUT FORCE (N)

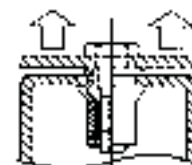

MATERIALE MATERIAL	TESTA HEAD	CORPO BODY	MISURA FILETTO THREAD SIZE						
			M3	M4	M5	M6	M8	M10	M12
FERRO C4C STEEL	TONDA FLAT	CILINDRICO E ESAGONALE ROUND AND HEXAGONAL	3900	6800	11500	16500	25000	32000	34000
	SVASATA COUNTERSUNK								
	RIDOTTA REDUCED								
INOX (ANSI 304) STAINLESS STEEL	TONDA FLAT	CILINDRICO E ESAGONALE ROUND AND HEXAGONAL	3900	6800	11500	16500	25000	32000	34000
	SVASATA COUNTERSUNK								
	RIDOTTA REDUCED								
ALLUMINIO Almg 2,5 ALUMINIUM	TONDA FLAT	CILINDRICO ROUND	1900	4000	6500	7800	12300	17500	-
	SVASATA COUNTERSUNK								
	RIDOTTA REDUCED								

INFORMAZIONI TECNICHE

TECHNICAL INFORMATION

TENUTA ALLA COPPIA DIRETTA (Nm) TORQUE-TO-TURN (Nm)

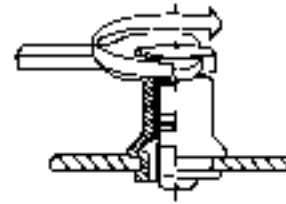

MATERIALE MATERIAL	TESTA HEAD	CORPO BODY	MISURA FILETTO THREAD SIZE						
			M3	M4	M5	M6	M8	M10	M12
FERRO C4C STEEL	TONDA FLAT	CILINDRICO ROUND	0,5	1	2	4,5	5,5	11	30
	SVASATA COUNTERSUNK		0,4	0,8	1,5	3,5	4,5	8,5	24
	RIDOTTA REDUCED		0,4	0,8	1,5	3,5	4,5	8,5	24
INOX (ANSI 304) STAINLESS STEEL	TONDA DOME	CILINDRICO ROUND	0,5	1	2	4,5	5,5	11	30
	SVASATA COUNTERSUNK		0,4	0,8	1,5	3,5	4,5	8,5	24
	RIDOTTA REDUCED		0,4	0,8	1,5	3,5	4,5	8,5	24
ALLUMINIO Almg 2,5 ALUMINIUM	TONDA DOME	CILINDRICO ROUND	0,25	0,9	1,5	3,5	5	6,5	21
	SVASATA COUNTERSUNK		0,2	0,7	1,2	2,5	4	5	16
	RIDOTTA REDUCED		0,2	0,7	1,2	2,5	4	5	16

VALORI AL TAGLIO (N) SHEAR FORCE (N)

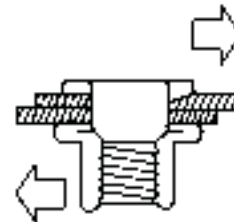

MATERIALE MATERIAL	TESTA HEAD	CORPO BODY	MISURA FILETTO THREAD SIZE						
			M3	M4	M5	M6	M8	M10	M12
FERRO C4C STEEL	TONDA FLAT	CILINDRICO E ESAGONALE ROUND AND HEXAGONAL	900	1500	2000	3000	4400	5000	6500
	SVASATA COUNTERSUNK								
	RIDOTTA REDUCED								
INOX (ANSI 304) STAINLESS STEEL	TONDA FLAT	CILINDRICO E ESAGONALE ROUND AND HEXAGONAL	900	1500	2000	3000	4400	5000	6500
	SVASATA COUNTERSUNK								
	RIDOTTA REDUCED								
ALLUMINIO Almg 2,5 ALUMINIUM	TONDA FLAT	CILINDRICO ROUND	600	1000	1200	2000	2400	3800	-
	SVASATA COUNTERSUNK								
	RIDOTTA REDUCED								

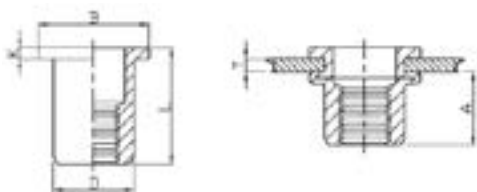

Unit: mm

FILETTO	TORSIONE Nm	CODICE	T (grip range) Min Max	A Ref	FORO +0.10	D +0.07 -0.1	B +/-0,3	K +/-0,2	L +/-0,3	Scheda Tecnica
M3	2	CF85ACITTM03C	0.5-1.5	4,7	5,0	4,9	7,2	0,8	8,5	Visualizza
M3	2	CF85ACITTM03L	1.5-2.5	4,7	5,0	4,9	7,2	0,8	9,5	Visualizza
M4	5	CF85ACITTM04C	0.5-2.0	6,0	6,0	5,9	8,5	0,8	10,3	Visualizza
M4	5	CF85ACITTM04L	2.0-3.5	6,0	6,0	5,9	8,5	0,8	12,0	Visualizza
M5	8,5	CF85ACITTM05C	0.5-2.5	7,5	7,0	6,9	10,0	1,0	13,0	Visualizza
M5	8,5	CF85ACITTM05L	2.5-5.0	8,5	7,0	6,9	10,0	1,0	17,0	Visualizza
M6	15	CF85ACITTM06C	0.5-3.0	9,2	9,0	8,9	12,3	1,3	15,5	Visualizza
M6	15	CF85ACITTM06L	3.0-5.5	9,2	9,0	8,9	12,3	1,3	18,0	Visualizza
M8	26	CF85ACITTM08C	0.5-3.5	11,5	11,0	10,9	15,0	1,5	18,5	Visualizza
M8	26	CF85ACITTM08L	3.5-6.0	11,5	11,0	10,9	15,0	1,5	21,0	Visualizza
M10	50	CF85ACITTM10C13	0.5-2.5	11,5	13,0	12,9	16,3	1,5	17,0	Visualizza
M10	50	CF85ACITTM10L13	2.5-4.0	12,5	13,0	12,9	17,0	1,6	21,0	Visualizza
M10	50	CF85ACITTM10C12	1.0-3.5	11,0	12,0	11,9	16,0	1,6	19,0	Visualizza
M12	80	CF85ACITTM12C15	1.0-4.0	13,5	15,0	14,9	18,0	1,7	22,0	Visualizza
M12	80	CF85ACITTM12L15	4.0-6.5	13,5	15,0	14,9	18,0	1,7	25,0	Visualizza
M12	80	CF85ACITTM12C16	1.0-4.0	16,0	16,0	15,9	22,0	2,0	25,0	Visualizza

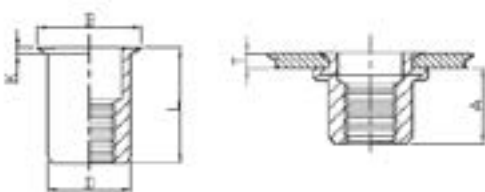

Unit: mm

FILETTO	TORSIONE Nm	CODICE	T (grip range) Min Max	A Ref	FORO +0.10	D +0.07 -0.1	B +/-0,3	K +/-0,2	L +/-0,3	Scheda Tecnica
M3	1	CF85ACITRM03C	0.5-1.5	6,2	5,0	4,9	6,0	0,5	9,0	Visualizza
M4	3	CF85ACITRM04C	0.5-2.0	6,5	6,0	5,9	7,0	0,5	10,5	Visualizza
M4	3	CF85ACITRM04L	2.0-4.0	6,5	6,0	5,9	7,0	0,5	13,0	Visualizza
M5	6	CF85ACITRM05C	0.5-2.0	7,0	7,0	6,9	8,0	0,5	11,5	Visualizza
M5	6	CF85ACITRM05L	2.0-4.0	7,0	7,0	6,9	8,0	0,5	13,0	Visualizza
M6	11	CF85ACITRM06C	0.5-2.5	8,5	9,0	8,9	10,5	0,6	14,0	Visualizza
M6	11	CF85ACITRM06L	2.5-5.0	8,5	9,0	8,9	10,0	0,6	17,0	Visualizza
M8	20	CF85ACITRM08C	0.5-3.0	10,0	11,0	10,9	12,0	0,65	16,5	Visualizza
M8	20	CF85ACITRM08L	3.0-5.0	10,0	11,0	10,9	12,0	0,65	18,5	Visualizza
M10	32	CF85ACITRM10C13	0.5-3.0	13,0	13,0	12,9	14,1	0,7	17,7	Visualizza
M10	32	CF85ACITRM10L13	3.0-5.5	13,0	13,0	12,9	14,1	0,7	21,0	Visualizza
M10	32	CF85ACITRM10C12	0.5-3.0	12,5	12,0	11,9	13,0	0,7	18,0	Visualizza

CFACITTG

TESTA TONDA CORPO CILINDRICO ZIGRINATO
FLATHEAD KNURLED BODY



INDICE/INDEX

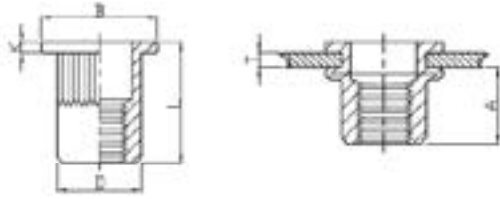

Unit: mm

FILETTO	TORSIONE Nm	CODICE	T (grip range) Min Max	A Ref	FORO +0.10	D +0.07 -0.1	B +/-0,3	K +/-0,2	L +/-0,3	Scheda Tecnica
M3	2	CF85ACITTM03C	0.5-1.5	6,0	5,0	4,9	8,0	0,8	10	Visualizza
M3	2	CF85ACITTM03L	2.0-3.0	6,0	5,0	4,9	8,0	0,8	11,0	Visualizza
M4	5	CF85ACITTM04C	0.5-2.0	6,0	6,0	5,9	9,0	0,8	10,5	Visualizza
M4	5	CF85ACITTM04L	2.0-3.5	6,0	6,0	5,9	9,0	0,8	12,0	Visualizza
M5	8,5	CF85ACITTM05C	0.5-2.5	7,5	7,0	6,9	10,0	1,0	13,0	Visualizza
M5	8,5	CF85ACITTM05L	2.5-5.0	8,5	7,0	6,9	10,0	1,0	16,5	Visualizza
M6	15	CF85ACITTM06C	0.5-3.0	9,2	9,0	8,9	12.30(*13.0)	1,3	15,5	Visualizza
M6	15	CF85ACITTM06L	3.0-5.5	10,5	9,0	8,9	12.30(*13.0)	1,3	19,5	Visualizza
M8	26	CF85ACITTM08C	1.0-3.5	11,5	11,0	10,9	14.5(*16.0)	1,5	18,5	Visualizza
M8	26	CF85ACITTM08L	3.5-6.0	11,5	11,0	10,9	14.5(*16.0)	1,5	21,0	Visualizza
M10	50	CF85ACITTM10C13	1.0-4.0	13,5	13,0	12,9	17.0(*19.0)	1,7	21,5	Visualizza
M10	50	CF85ACITTM10L13	4.0-6.5	13,5	13,0	12,9	17.0(*19.0)	1,7	24,0	Visualizza
M10	50	CF85ACITTM10C12	1.0-3.5	11,0	12,0	11,9	16,0	1,6	19,0	Visualizza
M12	80	CF85ACITTM12C15	1.0-4.0	13,5	15,0	14,9	18,0	1,7	22,0	Visualizza
M12	80	CF85ACITTM12L15	4.0-6.5	14,0	15,0	14,9	18,0	1,7	25,0	Visualizza
M12	80	CF85ACITTM12C16	1.0-4.0	15,0	16,0	15,9	22,0	2,0	25,0	Visualizza
M12	80	CF85ACITTM12L16	3.5-6.0	16,0	16,0	15,9	22,0	2,0	28,0	Visualizza

CFACITTCG

TESTA TONDA CORPO CILINDRICO ZIGRINATO CHIUSO
FLAT



HEAD KNURLED BODY CLOSE END

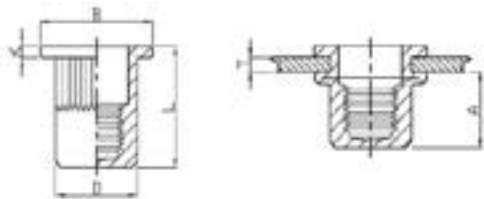

Unit: mm

FILETTO	TORSIONE Nm	CODICE	T (grip range) Min Max	A Ref	FORO +0.10	D +0.07 -0.1	B +/-0,3	K +/-0,2	L +/-0,3	Scheda Tecnica
M4	5	CF85ACITTCGM04C	0.5-2.0	11,3	6,0	5,9	9,0	0,8	16,0	Visualizza
M4	5	CF85ACITTCGM04L	2.0-4.0	11,3	6,0	5,9	9,0	0,8	18,0	Visualizza
M5	8,5	CF85ACITTCGM05C	0.5-3.0	11,5	7,0	6,9	10,0	1,0	17,0	Visualizza
M5	8,5	CF85ACITTCGM05L	3.0-5.0	11,5	7,0	6,9	10,0	1,0	19,0	Visualizza
M6	15	CF85ACITTCGM06C	0.5-3.0	12,7	9,0	8,9	12,3	1,3	19,2	Visualizza
M6	15	CF85ACITTCGM06L	3.0-5.0	12,7	9,0	8,9	12,3	1,3	21,0	Visualizza
M8	26	CF85ACITTCGM08C	1.0-3.0	14,8	11,0	10,9	15,0	1,50	21,5	Visualizza
M8	26	CF85ACITTCGM08L	3.0-6.0	14,8	11,0	10,9	15,0	1,50	24,0	Visualizza
M10	50	CF85ACITTCGM10C13	1.0-4.0	19,2	13,0	12,9	17,0	1,6	27,0	Visualizza

CFACITRG

TESTA RIDOTTA CORPO CILINDRICO ZIGRINATO
REDUCED HEAD KNURLED BODY



INDICE/INDEX

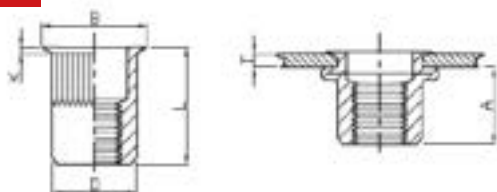

Unit: mm

FILETTO	TORSIONE Nm	CODICE	T (grip range) Min Max	A Ref	FORO +0.10	D +0.07 -0.1	B +/-0,3	K +/-0,2	L +/-0,3	Scheda Tecnica
M3	1	CF85ACITRGM03C	0.5-2.0	6,2	5,0	4,9	6,0	0,5	9,0	Visualizza
M3	1	CF85ACITRGM03L	1.5-3.0	6,2	5,0	4,9	6,0	0,5	11,5	Visualizza
M4	3	CF85ACITRGM04C	0.5-2.0	7,0	6,0	5,9	7,0	0,5	11,2	Visualizza
M4	3	CF85ACITRGM04L	2.0-4.0	7,0	6,0	5,9	7,0	0,5	13,0	Visualizza
M5	6	CF85ACITRGM05C	0.5-3.0	7,0	7,0	6,9	8,0	0,5	11,5	Visualizza
M5	6	CF85ACITRGM05L	3.0-4.0	7,0	7,0	6,9	8,0	0,5	13,0	Visualizza
M6	11	CF85ACITRGM06C	0.5-3.0	8,5	9,0	8,9	10,0	0,6	14,0	Visualizza
M6	11	CF85ACITRGM06L	3.0-5.0	8,5	9,0	8,9	10,0	0,6	16,0	Visualizza
M8	20	CF85ACITRGM08C	0.5-3.0	10,0	11,0	10,9	12,0	0,65	16,5	Visualizza
M8	20	CF85ACITRGM08L	3.0-5.0	10,0	11,0	10,9	12,0	0,65	18,5	Visualizza
M10	32	CF85ACITRGM10C13	1.0-3.5	12,5	13,0	12,9	14,0	0,7	19,5	Visualizza
M10	32	CF85ACITRGM10L13	3.5-6.0	12,5	13,0	12,9	14,0	0,7	22,0	Visualizza
M10	32	CF85ACITRGM10C12	1.0-3.5	12,5	12,0	11,9	13,0	0,7	19,5	Visualizza
M12	50	CF85ACITRGM12C15	1.0-3.5	15,2	15,0	14,9	16,5	0,85	22,5	Visualizza
M12	50	CF85ACITRGM12C16	1.0-4.0	16,2	16,0	15,9	17,5	0,86	24,2	Visualizza
M12	50	CF85ACITRGM12L16	4.0-6.5	16,2	16,0	15,9	17,5	0,80	27,5	Visualizza

CFACITRCG

TESTA RIDOTTA CORPO CILINDRICO ZIGRINATO CHIUSO
REDUCED HEAD KNURLED BODY CLOSE END

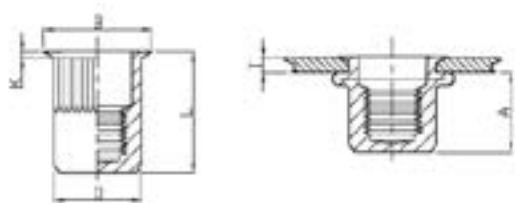

Unit: mm

FILETTO	TORSIONE Nm	CODICE	T (grip range) Min Max	A Ref	FORO +0.10	D +0.07 -0.1	B +/-0,3	K +/-0,2	L +/-0,3	Scheda Tecnica
M4	3	CF85ACITRCGM04C	0.5-2.0	11,0	6,0	5,9	7,0	0,5	15,0	Visualizza
M4	3	CF85ACITRCGM04L	2.0-3.5	11,0	6,0	5,9	7,0	0,5	16,5	Visualizza
M5	6	CF85ACITRCGM05C	0.5-2.0	12,5	7,0	6,9	8,0	0,5	16,5	Visualizza
M5	6	CF85ACITRCGM05L	2.0-3.5	12,5	7,0	6,9	8,0	0,5	18,0	Visualizza
M6	11	CF85ACITRCGM06C	0.5-3.0	15,5	9,0	8,9	10,0	0,6	20,5	Visualizza
M6	11	CF85ACITRCGM06L	3.0-4.5	15,5	9,0	8,9	10,0	0,6	22,0	Visualizza
M8	20	CF85ACITRCGM08C	0.5-3.0	17,0	11,0	10,9	12,0	0,65	23,0	Visualizza
M8	20	CF85ACITRCGM08L	3.0-4.5	17,0	11,0	10,9	12,0	0,65	24,5	Visualizza
M10	32	CF85ACITRCGM10C13	1.0-3.0	18,2	13,0	12,9	14,0	0,7	24,5	Visualizza
M10	32	CF85ACITRCGM10L13	3.0-5.0	18,2	13,0	12,9	14,0	0,7	26,0	Visualizza

INDICE/INDEX

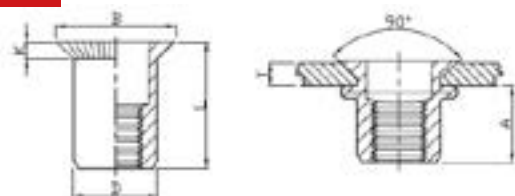

Unit: mm

FILETTO	TORSIONE Nm	CODICE	T (grip range) Min Max	A Ref	FORO +0.10	D +0.07 -0.1	B +/-0,3	K +/-0,2	L +/-0,3	Scheda Tecnica
M4	4	CF85ACITSM04C	1.5-3.0	6,5	6,0	5,9	9,0	1,5	12,0	Visualizza
M5	8	CF85ACITSM05C	1.5-3.5	7,5	7,0	6,9	10,0	1,5	13,0	Visualizza
M6	15	CF85ACITSM06C	1.5-4.0	9,0	9,0	8,9	12,0	1,5	15,5	Visualizza
M8	26	CF85ACITSM08C	2.0-4.5	11,0	11,0	10,9	14,0	1,5	18,5	Visualizza
M10	45	CF85ACITSM10C13	2.0-5.0	13,0	13,0	12,9	16,0	1,5	21,0	Visualizza

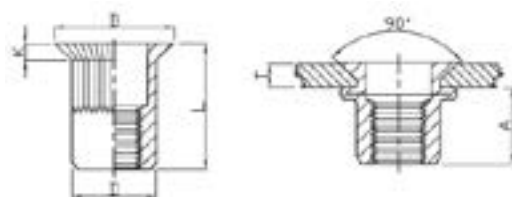

Unit: mm

FILETTO	TORSIONE Nm	CODICE	T (grip range) Min Max	A Ref	FORO +0.10	D +0.07 -0.1	B +/-0,3	K +/-0,2	L +/-0,3	Scheda Tecnica
M3	1	CF85ACITSGM03C	1.5-2.5	4,5	5,0	4,9	7,5	1,5	9,5	Visualizza
M4	4	CF85ACITSGM04C	1.5-3.0	6,5	6,0	5,9	9,0	1,5	12,0	Visualizza
M4	4	CF85ACITSGM04L	3.0-5.0	6,5	6,0	5,9	9,0	1,5	13,0	Visualizza
M5	8	CF85ACITSGM05C	1.5-3.5	7,5	7,0	6,9	10,0	1,5	13,0	Visualizza
M5	8	CF85ACITSGM05L	3.5-5.0	7,5	7,0	6,9	10,0	1,5	15,0	Visualizza
M6	15	CF85ACITSGM06C	1.5-4.0	9,0	9,0	8,9	12,0	1,5	15,5	Visualizza
M6	15	CF85ACITSGM06L	4.0-6.0	9,0	9,0	8,9	12,0	1,5	17,0	Visualizza
M8	26	CF85ACITSGM08C	2.0-4.5	11,0	11,0	10,9	14,0	1,5	18,5	Visualizza
M8	26	CF85ACITSGM08L	4.5-6.0	11,0	11,0	10,9	14,0	1,5	19,0	Visualizza
M10	45	CF85ACITSGM10C13	2.0-5.0	13,0	13,0	12,9	16,0	1,5	21,0	Visualizza
M10	45	CF85ACITSGM10L13	5.0-6.5	13,0	13,0	12,9	16,0	1,5	24,0	Visualizza
M12	70	CF85ACITSGM12C16	2.0-5.0	16,5	16,0	15,9	19,0	1,5	24,0	Visualizza
M12	70	CF85ACITSGM12L16	5.0-7.0	16,5	16,0	15,9	19,0	1,5	27,5	Visualizza

CFACITSCG

TESTA SVASATA CORPO CILINDRICO ZIGRINATO CHIUSO
COUNTERSUNK HEAD KNURLED BODY CLOSE END

INDICE/INDEX

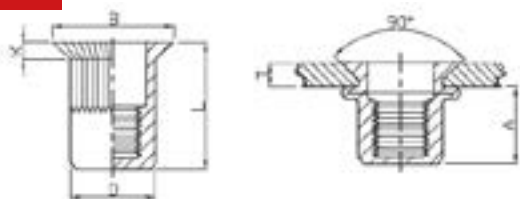

(MATERIALE DISPONILE SOLO SU RICHIESTA / ONLY ON DEMAND)

Unit: mm

FILETTO	TORSIONE Nm	CODICE	T (grip range) Min Max	A Ref	FORO +0.10	D +0.07 -0.1	B +/-0,3	K +/-0,2	L +/-0,3	Scheda Tecnica
M4	4	CF85ACITSCGM04C	1.5-3.0	12,3	6,0	5,9	9,0	1,5	17,5	Visualizza
M5	8	CF85ACITSCGM05C	1.5-3.5	14,0	7,0	6,9	10,0	1,5	19,5	Visualizza
M6	15	CF85ACITSCGM06C	1.5-4.0	17,5	9,0	8,9	12,0	1,5	23,5	Visualizza
M8	26	CF85ACITSCGM08C	1.5-4.0	20,0	11,0	10,9	14,0	1,5	26,5	Visualizza
M10	45	CF85ACITSCGM10C13	1.5-5.0	21,5	13,0	12,9	16,0	1,5	30,0	Visualizza

CFACITTSE

TESTA TONDA CORPO SEMI ESAGONALE
FLATHEAD SEMI-HEX BODY

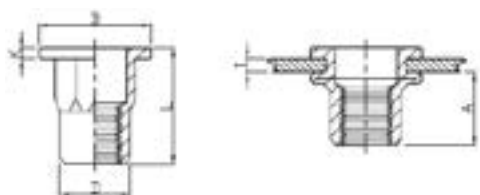

Unit: mm

FILETTO	TORSIONE Nm	CODICE	T (grip range) Min Max	A Ref	FORO +0.10	D +0.07 -0.1	B +/-0,3	K +/-0,2	L +/-0,3	Scheda Tecnica
M4	5	CF85ACITTSEM04C	0.5-2.0	6,5	6,0	5,9	9,0	0,8	11,0	Visualizza
M5	8,5	CF85ACITTSEM05C	0.5-2.5	8,0	7,0	6,9	10,0	1,0	13,0	Visualizza
M6	15	CF85ACITTSEM06C	0.5-3.0	8,5	9,0	8,9	12,7	1,35	15,0	Visualizza
M8	26	CF85ACITTSEM08C	1.0-3.5	10,5	11,0	10,9	16,0	1,5	18,0	Visualizza
M10	50	CF85ACITTSEM10C13	1.0-3.5	12,5	13,0	12,9	18,0	1,7	21,0	Visualizza
M10	50	CF85ACITTSEM10C12	1.0-3.5	11,0	12,0	11,9	17,0	1,6	19,0	Visualizza
M12	80	CF85ACITTSEM12C15	1.0-4.0	14,0	15,0	14,9	20,0	1,7	23,0	Visualizza
M12	80	CF85ACITTSEM12C16	2.0-5.0	16,5	16,0	15,9	23,0	2,2	27,5	Visualizza

INDICE/INDEX

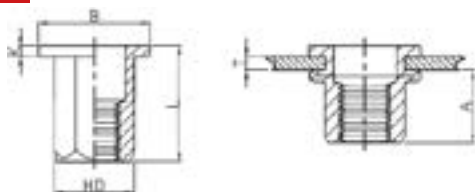

Unit: mm

FILETTO	TORSIONE Nm	CODICE	T (grip range) Min Max	A Ref	FORO +0.10	HD +0.07 -0.1	B +/-0,3	K +/-0,2	L +/-0,3	Scheda Tecnica
M3	2	CF85ACITTEM03C	0.5-2.0	5,0	5,0	5,0	7,0	0,8	8,8	Visualizza
M4	5	CF85ACITTEM04C	0.5-2.0	6,5	6,0	5,9	9,0	0,8	11,0	Visualizza
M4	5	CF85ACITTEM04L	2.0-4.0	6,5	6,0	5,9	9,0	0,8	13,0	Visualizza
M5	8,5	CF85ACITTEM05C	0.5-2.5	8,0	7,0	6,9	10,0	1,00	14,0	Visualizza
M5	8,5	CF85ACITTEM05L	2.5-5.0	8,0	7,0	6,9	10,0	1,00	16,5	Visualizza
M6	15	CF85ACITTEM06C	0.5-3.0	8,5	9,0	8,9	12.7(*13.0)	1,35	15.0(*16.0)	Visualizza
M6	15	CF85ACITTEM06L	3.0-5.5	8,5	9,0	8,9	13,0	1,35	19,5	Visualizza
M8	26	CF85ACITTEM08C	1.0-3.5	10,5	11,0	10,9	16,0	1,5	18,0	Visualizza
M8	26	CF85ACITTEM08L	3.0-5.5	10,5	11,0	10,9	16,0	1,5	21,0	Visualizza
M10	50	CF85ACITTEM10C13	1.0-3.5	12,5	13,0	12,9	18.0(*19.0)	1,7	21.0(*23.0)	Visualizza
M10	50	CF85ACITTEM10L13	3.5-6.0	12,5	13,0	12,9	19,0	1,7	24,0	Visualizza
M10	50	CF85ACITTEM10C12	1.0-3.5	13,5	12,0	11,9	18,0	1,7	21,0	Visualizza
M12	80	CF85ACITTEM12C15	1.0-4.0	14,0	15,0	14,9	20,0	1,7	23,0	Visualizza
M12	80	CF85ACITTEM12C16	2.0-5.0	16,5	16,0	15,9	23,0	2,0	27,0	Visualizza
M12	80	CF85ACITTEM12L16	5.0-8.0	16,5	16,0	15,9	23,0	2,0	30,0	Visualizza

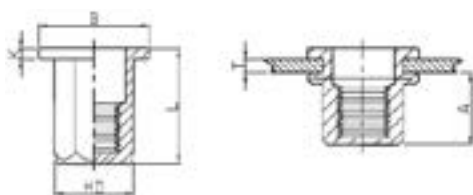

Unit: mm

FILETTO	TORSIONE Nm	CODICE	T (grip range) Min Max	A Ref	FORO +0.10	HD +0.07 -0.1	B +/-0,3	K +/-0,2	L +/-0,3	Scheda Tecnica
M4	5	CF85ACITTECM04C	0.5-2.0	11,0	6,0	5,9	9,0	1,0	15,0	Visualizza
M4	5	CF85ACITTECM04L	2.0-4.0	11,0	6,0	5,9	9,0	1,0	17,0	Visualizza
M5	8,5	CF85ACITTECM05C	0.5-2.5	13,5	7,0	6,9	10,0	1,0	18,0	Visualizza
M5	8,5	CF85ACITTECM05L	2.5-5.0	13,5	7,0	6,9	10,0	1,0	20,0	Visualizza
M6	15	CF85ACITTECM06C	0.5-3.0	17,0	9,0	8,9	12,7	1,5	23,0	Visualizza
M6	15	CF85ACITTECM06L	3.0-5.5	17,0	9,0	8,9	12,7	1,5	25,0	Visualizza
M8	26	CF85ACITTECM08C	1.0-3.5	19,0	11,0	10,9	16,0	1,5	26,0	Visualizza
M8	26	CF85ACITTECM08L	3.5-5.5	19,0	11,0	10,9	16,0	1,5	29,0	Visualizza
M10	50	CF85ACITTECM10C13	1.0-4.0	25,0	13,0	12,9	19,0	1,8	33,0	Visualizza
M10	50	CF85ACITTECM10L13	4.0-6.0	25,0	13,0	12,9	19,0	1,8	35,0	Visualizza

INDICE/INDEX

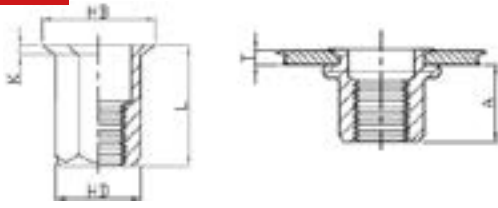

Unit: mm

FILETTO	TORSIONE Nm	CODICE	T (grip range) Min Max	A Ref	FORO +0.10	HD +0.07 -0.1	HB +/-0,3	K +/-0,2	L +/-0,3	Scheda Tecnica
M3	1	CF85ACIERM03C	0.5-1.5	5,5	5,0	4,9	6,0	0,5	8,5	Visualizza
M3	1	CF85ACIERM03L	1.5-3.0	5,5	5,0	4,9	6,0	0,5	10,5	Visualizza
M4	3	CF85ACIERM04C	0.5-2.5	6,7	6,0	5,9	7,0	0,5	11,0	Visualizza
M4	3	CF85ACIERM04L	2.5-5.0	6,7	6,0	5,9	7,0	0,5	13,5	Visualizza
M5	6	CF85ACIERM05C	0.5-3.0	9,0	7,0	6,9	8,0	0,60	14,5	Visualizza
M5	6	CF85ACIERM05L	3.0-5.0	9,0	7,0	6,9	8,0	0,60	16,0	Visualizza
M6	11	CF85ACIERM06C	1.0-3.5	10,0	9,0	8,9	10,0	0,6	16,0	Visualizza
M6	11	CF85ACIERM06L	3.5-6.0	10,0	9,0	8,9	10,0	0,6	18,0	Visualizza
M8	20	CF85ACIERM08C	1.0-4.0	11,5	11,0	10,9	12,0	0,70	18,0	Visualizza
M8	20	CF85ACIERM08L	4.0-6.0	11,5	11,0	10,9	12,0	0,70	20,0	Visualizza
M10	32	CF85ACIERM10C13	1.0-3.5	12,5	13,0	12,9	14,5	0,85	19,0	Visualizza
M10	32	CF85ACIERM10L13	3.5-6.0	14,5	13,0	12,9	14,5	0,85	23,5	Visualizza
M10	32	CF85ACIERM10C12	1.0-3.0	13,2	12,0	12,0	13,6	0,80	20,0	Visualizza
M12	50	CF85ACIERM12C15	1.0-4.0	14,0	15,0	14,9	16,9	0,80	25,5	Visualizza
M12	50	CF85ACIERM12C16	1.0-4.0	15,5	16,0	15,9	17,5	1,0	25,0	Visualizza
M12	50	CF85ACIERM12L16	4.0-7.0	15,5	16,0	15,9	17,5	1,0	28,0	Visualizza

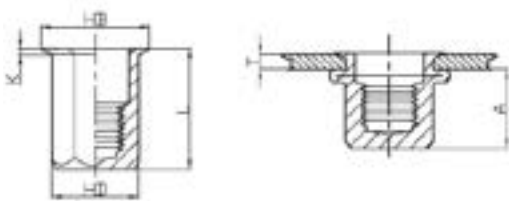

Unit: mm

FILETTO	TORSIONE Nm	CODICE	T (grip range) Min Max	A Ref	FORO +0.10	HD +0.07 -0.1	HB +/-0,3	K +/-0,2	L +/-0,3	Scheda Tecnica
M4	3	CF85ACIERCM04C	0.5-2.5	12,3	6,0	5,9	7,0	0,5	16,0	Visualizza
M4	3	CF85ACIERCM04L	2.5-4.0	12,3	6,0	5,9	7,0	0,5	18,0	Visualizza
M5	6	CF85ACIERCM05C	0.5-3.0	15,2	7,0	6,9	8,0	0,6	20,0	Visualizza
M5	6	CF85ACIERCM05L	3.0-5.0	15,2	7,0	6,9	8,0	0,6	23,0	Visualizza
M6	11	CF85ACIERCM06C	0.5-3.5	14,5	9,0	8,9	10,0	0,6	20,5	Visualizza
M6	11	CF85ACIERCM06L	3.5-5.5	14,5	9,0	8,9	10,0	0,6	23,5	Visualizza
M8	20	CF85ACIERCM08C	1.0-4.0	17,0	11,0	10,9	12,0	0,7	23,0	Visualizza
M8	20	CF85ACIERCM08L	4.0-6.0	17,0	11,0	10,9	12,0	0,7	25,0	Visualizza
M10	32	CF85ACIERCM10C13	1.0-4.0	20,0	13,0	12,9	14,5	0,85	28,5	Visualizza
M10	32	CF85ACIERCM10L13	4.0-6.0	20,0	13,0	12,9	14,5	0,85	30,5	Visualizza

CFACIERSE

TESTA RIDOTTA CORPO SEMI-ESAGONALE
REDUCED HEX HEAD INNER-HEX BODY



INDICE/INDEX

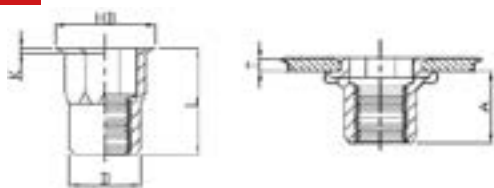

Unit: mm

FILETTO	TORSIONE Nm	CODICE	T (grip range) Min Max	A Ref	FORO +0.10	D +0.07 -0.1	HB +/-0,3	K +/-0,2	L +/-0,3	Scheda Tecnica
M3	1	CF85ACIERSEM03C	0.5-1.5	6,6	5,0	5,0	6,0	0,6	8,5	Visualizza
M4	3	CF85ACIERSEM04C	0.5-2.0	8,3	6,0	5,9	7,0	0,5	12,0	Visualizza
M5	6	CF85ACIERSEM05C	0.5-2.5	8,7	7,0	6,9	8,0	0,5	13,0	Visualizza
M6	11	CF85ACIERSEM06C	1.0-3.5	10,5	9,0	8,9	10,0	0,6	16,0	Visualizza
M8	20	CF85ACIERSEM08C	1.0-3.5	11,3	11,0	10,9	12,0	0,65	17,5	Visualizza
M10	32	CF85ACIERSEM10C13	1.0-4.0	12,8	13,0	12,9	14,5	0,75	21,0	Visualizza
M12	50	CF85ACIERSEM12C16	1.0-4.0	14,8	16,0	15,9	17,5	1,0	24,0	Visualizza

CFACITTSE

TESTA TONDA CORPO SEMI-ESAGONALE
FLATHEAD INNER-HEX BODY

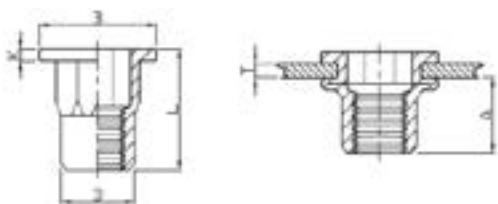

(MATERIALE DISPONIBILE SOLO SU RICHIESTA / ONLY ON DEMAND)

Unit: mm

FILETTO	TORSIONE Nm	CODICE	T (grip range) Min Max	A Ref	FORO +0.10	D +0.07 -0.1	B +/-0,3	K +/-0,2	L +/-0,3	Scheda Tecnica
M4	5	CF85ACITTSEM04C	0.5-2.0	7,0	6,0	5,9	9,0	0,8	11,0	Visualizza
M5	8,5	CF85ACITTSEM05C	0.5-2.5	7,5	7,0	6,9	10,0	1,0	12,0	Visualizza
M6	15	CF85ACITTSEM06C	0.5-3.0	9,2	9,0	8,9	12,7	1,35	15,5	Visualizza
M8	26	CF85ACITTSEM08C	1.0-3.5	11,2	11,0	10,9	16,0	1,5	18,0	Visualizza
M10	50	CF85ACITTSEM10C13	1.0-3.5	12,8	13,0	12,9	18,0	1,7	21,0	Visualizza

CFACITRGCP

TESTA RIDOTTA CORPO CILINDRICO ZIGRINATO FILETTO IN POLLICI
REDUCED HEAD KNURLED BODY



INDICE/INDEX

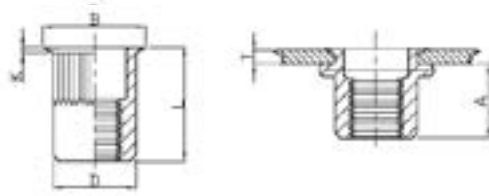

(MATERIALE DISPONIBILE SOLO SU RICHIESTA / ONLY ON DEMAND)

Unit: mm

FILETTO	TORSIONE Nm	CODICE	T (grip range) Min Max	A Ref	FORO +0.10	D ±0.05 (*+0.07-0.1)	B +/-0,3	K +/-0,2	L +/-0,3	Scheda Tecnica
M3	1	CF85ACITRGM03CP	0.5-1.5	5,5	4,8	4,65	5,4	0,4	9,0	Visualizza
M4	5	CF85ACITRGM04CP	0.5-2.0	6,5	6,5	6,35	7,0	0,5	10,5	Visualizza
M5	6	CF85ACITRGM05CP	0.5-2.5	7,5	7,25	7,15	7,85	0,5	12,0	Visualizza
M6	14	CF85ACITRGM06CP	1.0-3.0	9,2	9,6	9,45	10,3	0,6	15,0	Visualizza
M8	24	CF85ACITRGM08CP	1.0-3.5	10,5	10,6	10,45	11,3	0,6	16,0	Visualizza
M10	45	CF85ACITRGM10C13CP	1.0-4.0	12,8	12,8	12,65	13,8	0,65	20,0	Visualizza

CFACIERSECP

TESTA RIDOTTA CORPO SEMI-ESAGONALE FILETTO IN POLLICI
REDUCED HEX HEAD INNER-HEX BODY-UK

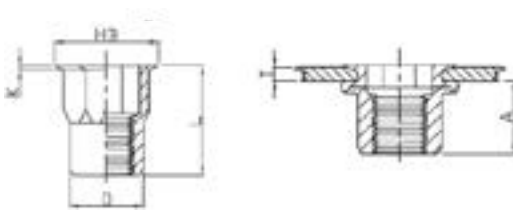

Unit: mm

FILETTO	TORSIONE Nm	CODICE	T (grip range) Min Max	A Ref	FORO +0.10	D ±0.05 (*±0.08)	HB +/-0,3	K +/-0,2	L +/-0,3	Scheda Tecnica
M4	3	CF85ACIERSEM04CP	0.5-2.0	6,5	6,4	6,25	7,25	0,5	10,5	Visualizza
M5	6	CF85ACIERSEM05CP	0.5-2.5	7,5	7,2	7,05	8,1	0,5	12,0	Visualizza
M6	11	CF85ACIERSEM06CP	1.0-3.0	9,2	9,6	9,45	10,5	0,6	15,0	Visualizza
M8	20	CF85ACIERSEM08CP	1.0-3.5	10,5	10,6	10,45	11,5	0,65	16,5	Visualizza

CFIXITT

TESTA TONDA CORPO CILINDRICO LISCIO IN ACCIAIO INOX
FLATHEAD ROUND BODY PLAIN STAINLESS STEEL



INDICE/INDEX

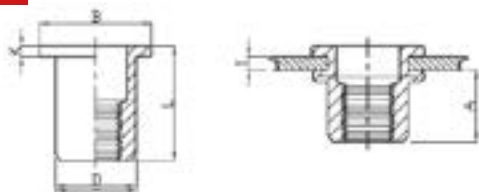

INOX A2



Unit: mm

FILETTO	TORSIONE Nm	CODICE	T (grip range) Min Max	A Ref	FORO +0.10	D +0.07 -0.1	B +/-0,3	K +/-0,2	L +/-0,3	Scheda Tecnica
M3	2	CF85IXITTM03C	0.5-2.0	4,5	5,0	4,9	7,0	0,8	8,8	Visualizza
M4	5	CF85IXITTM04C	0.5-2.0	6,0	6,0	5,9	9,0	0,8	10,8	Visualizza
M5	8,5	CF85IXITTM05C	0.5-2.5	7,0	7,0	6,9	10,0	1,0	13,0	Visualizza
M6	15	CF85IXITTM06C	0.5-3.0	8,5	9,0	8,9	13,0	1,5	15,0	Visualizza
M8	26	CF85IXITTM08C	0.5-3.5	11,0	11,0	10,9	15,0	1,5	18,0	Visualizza
M10	50	CF85IXITTM10C13	1.0-3.5	12,0	13,0	12,9	17,0	1,8	20,3	Visualizza
M12	80	CF85IXITTM12C15	1.0-3.5	16,0	16,0	15,9	19,0	1,8	22,0	Visualizza
M12	80	CF85IXITTM12C16	1.0-3.5	16,0	15,0	14,9	19,0	1,8	22,0	Visualizza

CFIXITR

TESTA RIDOTTA CORPO CILINDRICO LISCIO IN ACCIAIO INOX
REDUCE HEAD ROUND BODY PLAIN STAINLESS STEEL

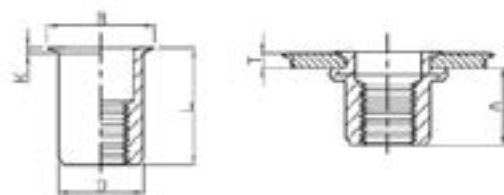

INOX A2



Unit: mm

FILETTO	TORSIONE Nm	CODICE	T (grip range) Min Max	A Ref	FORO +0.10	D +0.07 -0.1	B +/-0,3	K +/-0,2	L +/-0,3	Scheda Tecnica
M3	1	CF85IXITRM03C	0.5-1.5	5,0	5,0	4,9	5,5	0,35	8,5	Visualizza
M4	3	CF85IXITRM04C	0.5-1.5	5,5	6,0	5,9	7,0	0,50	10,0	Visualizza
M5	6	CF85IXITRM05C	0.5-2.0	6,0	7,0	6,9	8,0	0,60	12,0	Visualizza
M6	11	CF85IXITRM06C	0.5-3.0	9,0	9,0	8,9	10,0	0,60	14,5	Visualizza
M8	20	CF85IXITRM08C	0.5-3.5	10,0	11,0	10,9	12,3	0,60	16,5	Visualizza
M10	32	CF85IXITRM10C13	0.5-3.5	12,0	13,0	12,9	14,5	0,85	19,0	Visualizza
M12	32	CF85IXITRM12C15	0.5-3.5	14,5	15,0	14,9	16,5	0,85	22,5	Visualizza

CFIXITTG

TESTA TONDA CORPO CILINDRICO ZIGRINATO IN ACCIAIO INOX
FLATHEAD KNURLED BODY STAINLESS STEEL



INDICE/INDEX

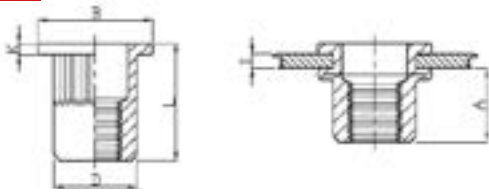

INOX A2/A4



Unit: mm

FILETTO	TORSIONE Nm	CODICE	T (grip range) Min Max	A Ref	FORO +0.10	D +0.07 -0.1	B +/-0,3	K +/-0,2	L +/-0,3	Scheda Tecnica
M3	2	CF85IXITTM03C	0.5-2.0	4,5	5,0	5,0	7,0	0,8	8,8	Visualizza
M3	2	CF85IXITTM03L	2.0-3.0	6,2	5,0	4,9	7,0	0,8	10,5	Visualizza
M4	5	CF85IXITTM04C	0.5-2.0	6,5	6,0	5,9	9,0	0,8	10,5	Visualizza
M4	5	CF85IXITTM04L	2.0-4.0	6,5	6,0	5,9	9,0	0,8	13,0	Visualizza
M5	8,5	CF85IXITTM05C	0.5-2.5	8,0	7,0	6,9	10,0	1,0	13,0	Visualizza
M5	8,5	CF85IXITTM05L	2.5-4.5	8,0	7,0	6,9	10,0	1,0	16,5	Visualizza
M6	15	CF85IXITTM06C	0.5-3.0	9,2	9,0	8,9	12,3	1,3	15,5	Visualizza
M6	15	CF85IXITTM06L	3.5-5.0	9,2	9,0	8,9	12,3	1,3	19,5	Visualizza
M8	26	CF85IXITTM08C	1.0-3.5	11,5	11,0	10,9	14,5	1,5	18,5	Visualizza
M8	26	CF85IXITTM08L	3.5-6.0	11,5	11,0	10,9	14,5	1,5	20,0	Visualizza
M10	50	CF85IXITTM10C13	1.0-3.5	13,5	13,0	12,9	17,0	1,6	21,0	Visualizza
M10	50	CF85IXITTM10L13	4.0-5.5	13,5	13,0	12,9	19,0	2,0	22,0	Visualizza
M10	50	CF85IXITTM10C12	0.8-3.5	11,0	12,0	11,9	16,0	1,7	19,0	Visualizza
M12	80	CF85IXITTM12C16	1.0-4.0	16,0	16,0	15,9	23,0	2,0	23,0	Visualizza
M12	80	CF85IXITTM12L16	3.5-5.5	18,0	16,0	15,9	19,0	1,8	24,3	Visualizza
M12	80	CF85IXITTM12C15	1.0-3.5	16,0	15,0	14,9	19,0	1,8	22,0	Visualizza
M12	80	CF85IXITTM12L15	3.5-5.5	18,0	15,0	14,9	19,0	1,8	24,3	Visualizza

CFIXITTCG

TESTA TONDA CORPO CILINDRICO ZIGRINATO CHIUSO ACCIAIO INOX
FLATHEAD KNURLED BODY CLOSE END STAINLESS STEEL

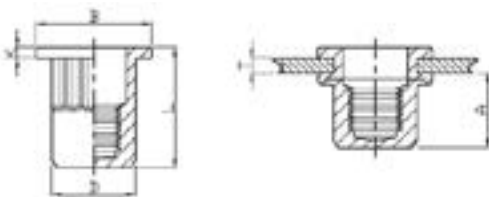

INOX A2



Unit: mm

FILETTO	TORSIONE Nm	CODICE	T (grip range) Min Max	A Ref	FORO +0.10	D +0.07 -0.1	B +/-0,3	K +/-0,2	L +/-0,3	Scheda Tecnica
M4	5	CF85IXITTCGM04C	0.5-2.0	11,8	6,0	5,9	9,0	0,8	16,0	Visualizza
M4	5	CF85IXITTCGM04L	1.0-2.5	11,8	6,0	5,9	9,0	0,8	18,0	Visualizza
M5	8,5	CF85IXITTCGM05C	0.5-2.5	12,0	7,0	6,9	10,0	1,0	17,0	Visualizza
M5	8,5	CF85IXITTCGM05L	2.5-4.0	12,0	7,0	6,9	10,0	1,0	19,0	Visualizza
M6	15	CF85IXITTCGM06C	0.5-3.0	12,7	9,0	8,9	13,0	1,5	19,2	Visualizza
M6	15	CF85IXITTCGM06L	3.0-5.5	12,7	9,0	8,9	13,0	1,5	21,0	Visualizza
M8	26	CF85IXITTCGM08C	0.5-3.5	14,2	11,0	10,9	15,0	1,5	21,5	Visualizza
M8	26	CF85IXITTCGM08L	3.5-6.0	14,2	11,0	10,9	15,0	1,5	24,0	Visualizza
M10	50	CF85IXITTCGM10C13	0.5-3.5	18,0	13,0	12,9	17,0	1,8	27,0	Visualizza
M10	50	CF85IXITTCGM10L13	3.5-6.0	18,0	13,0	12,9	17,0	1,8	34,3	Visualizza
M12	80	CF85IXITTCGM12C16	0.5-3.0	29,5	16,0	15,9	23,0	2,0	39,0	Visualizza

CFIXITRG

TESTA RIDOTTA CORPO CILINDRICO ZIGRINATO IN ACCIAIO INOX
REDUCE HEAD KNURLED BODY STAINLESS STEEL



INDICE/INDEX

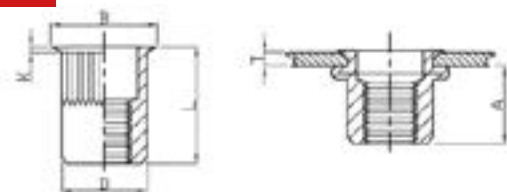

INOX A2/A4



Unit: mm

FILETTO	TORSIONE Nm	CODICE	T (grip range) Min Max	A Ref	FORO +0.10	D +0.07 -0.1	B +/-0,3	K +/-0,2	L +/-0,3	Scheda Tecnica
M3	1	CF85IXITRGM03C	0.5-1.5	6,8	5,0	5,0	6,0	0,60	8,5	Visualizza
M3	1	CF85IXITRGM03L	1.5-2.5	6,0	5,0	4,9	5,5	0,35	9,5	Visualizza
M4	3	CF85IXITRGM04C	0.5-2.0	6,5	6,0	5,9	7,0	0,50	10,5	Visualizza
M4	3	CF85IXITRGM04L	2.0-4.0	6,5	6,0	5,9	7,0	0,50	13,0	Visualizza
M5	6	CF85IXITRGM05C	0.5-2.0	7,2	7,0	6,9	8,0	0,50	11,5	Visualizza
M5	6	CF85IXITRGM05L	2.0-4.0	7,2	7,0	6,9	8,0	0,50	13,0	Visualizza
M6	11	CF85IXITRGM06C	0.5-2.5	8,7	9,0	8,9	10,0	0,60	14,0	Visualizza
M6	11	CF85IXITRGM06L	3.0-4.5	8,7	9,0	8,9	10,0	0,60	17,5	Visualizza
M8	20	CF85IXITRGM08C	0.5-3.0	10,5	11,0	10,9	12,0	0,65	16,5	Visualizza
M8	20	CF85IXITRGM08L	3.0-5.0	10,5	11,0	10,9	12,0	0,65	18,5	Visualizza
M10	32	CF85IXITRGM10C13	1.0-3.5	10,7	13,0	12,9	14,0	0,70	17,7	Visualizza
M10	32	CF85IXITRGM10L13	1.0-3.5	10,7	12,0	11,9	13,0	0,70	17,7	Visualizza
M12	50	CF85IXITRGM12C16	1.0-3.5	16,0	16,0	15,9	17,6	0,75	24,2	Visualizza

CFIXITRCG

TESTA RIDOTTA CORPO CILINDRICO ZIGRINATO CHIUSO IN ACCIAIO INOX
REDUCE HEAD KNURLED BODY CLOSE END STAINLESS STEEL

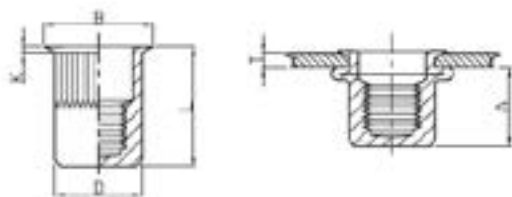

INOX A2



Unit: mm

FILETTO	TORSIONE Nm	CODICE	T (grip range) Min Max	A Ref	FORO +0.10	D +0.07 -0.1	B +/-0,3	K +/-0,2	L +/-0,3	Scheda Tecnica
M3	1	CF85IXITRCGM03C	0.5-1.5	10,5	5,0	4,9	6,0	0,50	11,0	Visualizza
M3	1	CF85IXITRCGM03L	1.5-2.5	10,5	5,0	4,9	6,0	0,50	13,0	Visualizza
M4	3	CF85IXITRCGM04C	0.5-2.0	11,0	6,0	5,9	7,0	0,50	15,0	Visualizza
M4	3	CF85IXITRCGM04L	2.0-4.0	11,0	6,0	5,9	7,0	0,50	16,5	Visualizza
M5	6	CF85IXITRCGM05C	0.5-2.5	12,5	7,0	6,9	8,0	0,60	16,5	Visualizza
M5	6	CF85IXITRCGM05L	2.5-4.5	12,5	7,0	6,9	8,0	0,60	18,0	Visualizza
M6	11	CF85IXITRCGM06C	0.5-3.0	15,5	9,0	8,9	10,0	0,60	20,5	Visualizza
M6	11	CF85IXITRCGM06L	3.0-4.5	15,5	9,0	8,9	10,0	0,60	22,0	Visualizza
M8	20	CF85IXITRCGM08C	0.5-3.5	17,0	11,0	10,9	12,3	0,60	23,0	Visualizza
M8	20	CF85IXITRCGM08L	3.0-4.5	17,0	11,0	10,9	12,3	0,60	24,5	Visualizza
M10	32	CF85IXITRCGM10C13	0.5-3.5	18,2	13,0	12,9	14,5	0,85	24,5	Visualizza
M10	32	CF85IXITRCGM10L13	3.0-5.0	18,2	13,0	12,9	14,5	0,85	26,0	Visualizza
M12	50	CF85IXITRCGM12C15	2.0-4.0	20,0	15,0	14,9	16,5	0,85	28,0	Visualizza

INDICE/INDEX

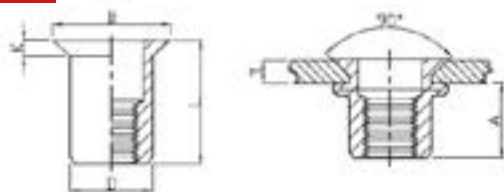

INOX A2



(MATERIALE DISPONIBILE SOLO SU RICHIESTA / ONLY ON DEMAND)

Unit: mm

FILETTO	TORSIONE Nm	CODICE	T (grip range) Min Max	A Ref	FORO +0.10	D +0.07 -0.1	B +/-0,3	K +/-0,2	L +/-0,3	Scheda Tecnica
M3	1	CF85IXITSM03C	1.5-3.0	5,0	5,0	4,9	7,8	1,5	9,5	Visualizza
M4	4	CF85IXITSM04C	1.5-3.0	6,0	6,0	5,9	9,0	1,5	11,0	Visualizza
M5	8	CF85IXITSM05C	1.5-3.5	8,0	7,0	6,9	10,0	1,5	14,0	Visualizza
M6	15	CF85IXITSM06C	1.5-4.0	9,0	9,0	8,9	12,0	1,5	15,0	Visualizza
M8	26	CF85IXITSM08C	1.5-4.5	10,0	11,0	10,9	14,0	1,5	16,5	Visualizza
M10	45	CF85IXITSM10C13	1.5-4.5	11,0	13,0	12,9	16,0	1,7	19,0	Visualizza
M12	65	CF85IXITSM12C15	1.5-5.0	13,5	15,0	14,9	18,0	1,8	22,5	Visualizza

CFIXITSG

TESTA SVASATA CORPO CILINDRICO ZIGRINATO IN ACCIAIO INOX
COUNTERSUNK HEAD KNURLED BODY STAINLESS STEEL



INDICE/INDEX

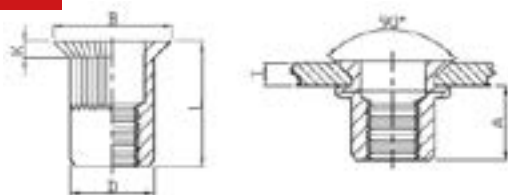

INOX A2



Unit: mm

FILETTO	TORSIONE Nm	CODICE	T (grip range) Min Max	A Ref	FORO +0.10	D +0.07 -0.1	B +/-0,3	K +/-0,2	L +/-0,3	Scheda Tecnica
M3	1	CF85IXITSGM03C	1.0-2.0	5,0	5,0	4,9	7,8	1,5	9,5	Visualizza
M3	1	CF85IXITSGM03L	2.0-3.0	6,0	5,0	4,9	7,8	1,5	10,5	Visualizza
M4	4	CF85IXITSGM04C	1.5-3.5	7,5	6,0	5,9	9,0	1,5	12,0	Visualizza
M4	4	CF85IXITSGM04L	3.5-5.0	8,0	6,0	5,9	9,0	1,5	13,0	Visualizza
M5	8	CF85IXITSGM05C	1.5-3.5	7,8	7,0	6,9	10,0	1,5	13,0	Visualizza
M5	8	CF85IXITSGM05L	3.5-5.0	9,0	7,0	6,9	10,0	1,5	15,0	Visualizza
M6	15	CF85IXITSGM06C	1.5-4.0	9,0	9,0	8,9	12,0	1,5	15,5	Visualizza
M6	15	CF85IXITSGM06L	4.0-6.0	11,0	9,0	8,9	12,0	1,5	17,0	Visualizza
M8	26	CF85IXITSGM08C	2.0-4.5	12,0	11,0	10,9	14,0	1,5	18,5	Visualizza
M8	26	CF85IXITSGM08L	3.5-6.5	12,5	11,0	10,9	14,0	1,5	21,0	Visualizza
M10	45	CF85IXITSGM10C13	2.0-5.0	13,0	13,0	12,9	16,0	1,5	21,0	Visualizza
M10	45	CF85IXITSGM10L13	4.5-6.0	12,5	13,0	12,9	16,0	1,7	20,5	Visualizza
M12	50	CF85IXITSGM12C15	1.6-5.0	13,5	15,0	14,9	18,0	1,8	22,5	Visualizza

CFIXITSCG

TESTA SVASATA CORPO CILINDRICO ZIGRINATO CIECO IN ACCIAIO INOX
COUNTERSUNK HEAD KNURLED BODY CLOSE END STAINLESS STEEL

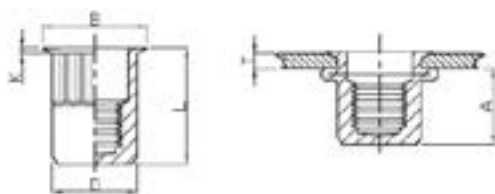

INOX A2



Unit: mm

(MATERIALE DISPONIBILE SOLO SU RICHIESTA / ONLY ON DEMAND)

FILETTO	TORSIONE Nm	CODICE	T (grip range) Min Max	A Ref	FORO +0.10	D +0.07 -0.1	B +/-0,3	K +/-0,2	L +/-0,3	Scheda Tecnica
M4	3	CF85IXITSCGM04C	1.6-3.5	12,3	6,0	5,9	9,0	1,5	17,3	Visualizza
M5	6	CF85IXITSCGM05C	1.6-3.5	13,5	7,0	6,9	10,0	1,5	19,5	Visualizza
M6	11	CF85IXITSCGM06C	1.6-4.0	17,5	9,0	8,9	12,0	1,5	23,5	Visualizza
M8	20	CF85IXITSCGM08C	1.6-4.5	20,0	11,0	10,9	14,0	1,5	26,5	Visualizza
M10	32	CF85IXITSCGM10C13	1.6-5.0	25,5	13,0	12,9	16,0	1,7	33,0	Visualizza
M12	50	CF85IXITSCGM12C16	1.6-3.5	29,5	16,0	15,9	19,0	1,8	38,0	Visualizza

CFIXIERSE

TESTA RIDOTTA CORPO SEMI-ESAGONALE IN ACCIAIO INOX
REDUCE HEX HEAD INNER-HEX BODY STAINLESS STEEL



INDICE/INDEX

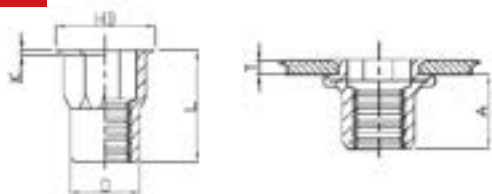

INOX A2/A4



Unit: mm

FILETTO	TORSIONE Nm	CODICE	T (grip range) Min Max	A Ref	FORO +0.10	D +0.07 -0.1	HB +/-0,3	K +/-0,2	L +/-0,3	Scheda Tecnica
M3	1	CF85XIERSEM03C	0.5-1.5	5,5	5,0	4,9	6,0	0,5	9,0	Visualizza
M3	1	CF85XIERSEM03L	1.5-2.5	5,5	5,0	4,9	6,0	0,5	11,0	Visualizza
M4	3	CF85XIERSEM04C	0.5-2.0	8,0	6,0	5,9	7,0	0,5	12,0	Visualizza
M4	3	CF85XIERSEM04L	2.0-4.0	8,0	6,0	5,9	7,0	0,5	14,0	Visualizza
M5	6	CF85XIERSEM05C	0.5-2.5	8,2	7,0	6,9	8,0	0,5	13,0	Visualizza
M5	6	CF85XIERSEM05L	2.5-4.0	8,2	7,0	6,9	8,0	0,5	15,0	Visualizza
M6	11	CF85XIERSEM06C	1.0-3.0	10,7	9,0	8,9	10,0	0,6	16,0	Visualizza
M6	11	CF85XIERSEM06L	3.0-5.0	10,7	9,0	8,9	10,0	0,6	18,0	Visualizza
M8	20	CF85XIERSEM08C	1.0-3.5	11,2	11,0	10,9	12,0	0,65	17,5	Visualizza
M8	20	CF85XIERSEM08L	3.5-5.0	11,2	11,0	10,9	12,0	0,65	19,5	Visualizza
M10	32	CF85XIERSEM10C13	1.0-4.0	13,5	13,0	12,9	14,5	0,75	21,0	Visualizza
M10	32	CF85XIERSEM10C12	1.0-4.0	13,5	12,0	11,9	13,0	0,8	18,0	Visualizza
M10	32	CF85XIERSEM10L13	4.0-5.5	13,5	13,0	12,9	14,5	0,75	23,0	Visualizza
M12	50	CF85XIERSEM12C16	1.0-4.0	14,8	16,0	15,9	17,5	0,8	24,0	Visualizza
M12	50	CF85XIERSEM12L16	4.0-6.0	14,8	16,0	15,9	17,5	0,8	27,0	Visualizza

CFIXIERSEC

TESTA RIDOTTA CORPO SEMI-ESAGONALE IN ACCIAIO INOX CHIUSI
REDUCE HEAD INNER-HEX BODY CLOSE END STAINLESS STEEL

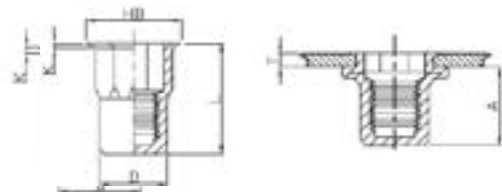

INOX A2/A4



Unit: mm

FILETTO	TORSIONE Nm	CODICE	T (grip range) Min Max	A Ref	FORO +0.10	D +0.07 -0.1	HB +/-0,3	K +/-0,2	L +/-0,3	Scheda Tecnica
M3	1	CF85XIERSECM03C	0.5-1.5	9,5	5,0	4,9	6,0	0,5	13,0	Visualizza
M3	1	CF85XIERSECM03L	1.5-2.5	9,5	5,0	4,9	6,0	0,5	15,0	Visualizza
M4	3	CF85XIERSECM04C	0.5-2.0	11,5	6,0	5,9	7,0	0,5	15,5	Visualizza
M4	3	CF85XIERSECM04L	2.0-4.0	11,5	6,0	5,9	7,0	0,5	17,5	Visualizza
M5	6	CF85XIERSECM05C	0.5-2.5	13,5	7,0	6,9	8,0	0,5	18,0	Visualizza
M5	6	CF85XIERSECM05L	2.5-4.0	13,5	7,0	6,9	8,0	0,6	20,0	Visualizza
M6	11	CF85XIERSECM06C	0.5-3.0	15,8	9,0	8,9	10,0	0,6	21,5	Visualizza
M6	11	CF85XIERSECM06L	3.0-5.0	15,8	9,0	8,9	10,0	0,6	23,0	Visualizza
M8	20	CF85XIERSECM08C	1.0-3.5	18,2	11,0	10,9	12,0	0,7	24,0	Visualizza
M8	20	CF85XIERSECM08L	3.5-5.5	18,2	11,0	10,9	12,0	0,65	26,0	Visualizza
M10	32	CF85XIERSECM10C13	1.0-4.0	23,2	13,0	12,9	14,5	0,80	30,5	Visualizza
M10	32	CF85XIERSECM10L13	4.0-5.5	23,2	13,0	12,9	14,5	0,9	33,0	Visualizza

CFIXITTSE

TESTA TONDA CORPO SEMI-ESAGONALE IN ACCIAIO INOX
FLATHEAD INNER-HEX BODY STAINLESS STEEL



INDICE/INDEX

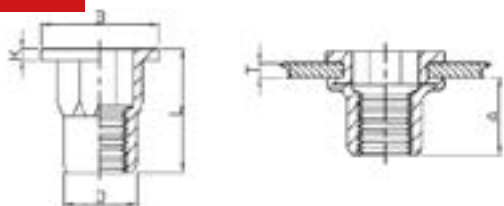

INOX A2/A4



Unit: mm

FILETTO	TORSIONE Nm	CODICE	T (grip range) Min Max	A Ref	FORO +0.10	D +0.07 -0.1	B +/-0,3	K +/-0,2	L +/-0,3	Scheda Tecnica
M3	2	CF85IXITTSEM03C	0.5-1.5	6,6	5,0	4,9	6,0	0,6	8,5	Visualizza
M4	5	CF85IXITTSEM04C	0.5-2.0	7,2	6,0	5,9	9,0	0,8	11,0	Visualizza
M4	5	CF85IXITTSEM04L	2.5-3.5	8,2	6,0	5,9	9,0	0,8	13,0	Visualizza
M5	8,5	CF85IXITTSEM05C	0.5-2.5	7,5	7,0	6,9	10,0	1,0	12,0	Visualizza
M5	8,5	CF85IXITTSEM05L	2.5-3.5	9,5	7,0	6,9	10,0	1,0	14,5	Visualizza
M6	15	CF85IXITTSEM06C	0.5-3.0	9,2	9,0	8,9	12,7	1,3	15,5	Visualizza
M6	15	CF85IXITTSEM06L	3.5-5.0	12,2	9,0	8,9	13,0	1,5	19,0	Visualizza
M8	26	CF85IXITTSEM08C	1.0-3.5	11,0	11,0	10,9	16,0	1,5	18,0	Visualizza
M8	26	CF85IXITTSEM08L	3.5-5.0	12,0	11,0	10,9	15,0	1,5	19,0	Visualizza
M10	50	CF85IXITTSEM10C13	1.0-4.0	13,2	13,0	12,9	18,0	1,7	21,0	Visualizza
M10	50	CF85IXITTSEM10L13	3.5-5.0	14,2	13,0	12,9	17,0	1,8	22,0	Visualizza
M12	80	CF85IXITTSEM12C16	2.5-5.0	16,0	16,0	15,9	23,0	2,0	25,0	Visualizza

CFIXITTSEC

TESTA TONDA CORPO SEMI-ESAGONALE CHIUSO ACCIAIO INOX
FLATHEAD INNER-HEX BODY CLOSE END STAINLESS STEEL

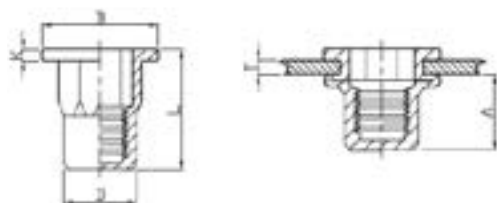

INOX A2/A4



Unit: mm

FILETTO	TORSIONE Nm	CODICE	T (grip range) Min Max	A Ref	FORO +0.10	D +0.07 -0.1	B +/-0,3	K +/-0,2	L +/-0,3	Scheda Tecnica
M4	5	CF85IXITTSECM04C	0.5-2.0	11,5	6,0	5,9	9,0	1,0	16,0	Visualizza
M5	8,5	CF85IXITTSECM05C	0.5-2.5	13,5	7,0	6,9	10,0	1,0	18,5	Visualizza
M6	15	CF85IXITTSECM06C	0.5-3.0	17,5	9,0	8,9	12,7	1,5	23,0	Visualizza
M8	26	CF85IXITTSECM08C	1.0-3.5	18,2	11,0	10,9	16,0	1,5	25,0	Visualizza
M10	50	CF85IXITTSECM10C13	1.0-4.0	25,0	13,0	12,9	19,0	1,7	33,0	Visualizza

INDICE/INDEX

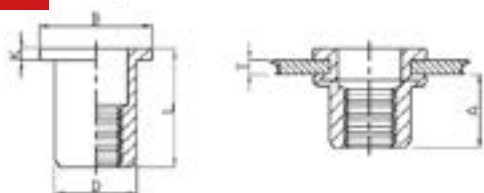

ALLUMINIO
Al Mg 2,5



Unit: mm

THREAD	P/N	LD P/N	T (grip range) Min Max	A Ref	FORO +0.10	D +0.07 -0.1	B	K	L	Scheda Tecnica
M3	0,7	CF85ALITTM03C	0.5-1.5	5,5	5,0	4,9	8,0	0,75	9,0	Visualizza
M4	2,5	CF85ALITTM04C	0.5-2.0	6,0	6,0	5,9	8,8	0,8	10,5	Visualizza
M5	5	CF85ALITTM05C	0.5-2.5	7,5	7,0	6,9	10,0	1,0	13,0	Visualizza
M6	8	CF85ALITTM06C	0.5-2.5	9,2	9,0	8,9	12,3	1,5	15,0	Visualizza
M8	20	CF85ALITTM08C	1.0-3.0	10,2	11,0	10,9	14,3	1,5	16,5	Visualizza
M10	25	CF85ALITTM10C13	1.0-4.0	11,5	13,0	12,9	16,3	1,6	19,0	Visualizza

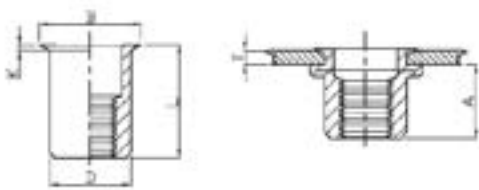

ALLUMINIO
Al Mg 2,5



Unit: mm

FILETTO	TORSIONE Nm	CODICE	T (grip range) Min Max	A Ref	FORO +0.10	D +0.07 -0.1	B	K	L	Scheda Tecnica
M3	0,7	CF85ALITRM03C	0.5-1.5	5,5	5,0	4,9	5,6	0,35	8,5	Visualizza
M4	2,5	CF85ALITRM04C	0.5-2.0	6,0	6,0	5,9	7,0	0,5	10,5	Visualizza
M5	5	CF85ALITRM05C	0.5-2.0	7,5	7,0	6,9	8,0	0,5	11,5	Visualizza
M6	8	CF85ALITRM06C	0.5-2.5	9,2	9,0	8,9	10,0	0,6	14,0	Visualizza
M8	20	CF85ALITRM08C	0.5-2.5	10,2	11,0	10,9	12,0	0,65	15,5	Visualizza
M10	25	CF85ALITRM10C13	1.0-3.0	11,5	13,0	12,9	14,1	0,7	17,7	Visualizza

INDICE/INDEX

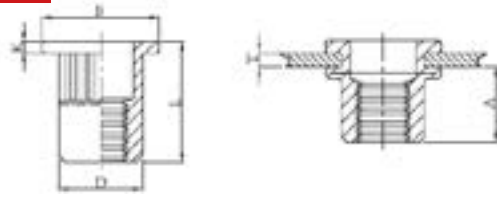

ALLUMINIO
Al Mg 2,5



(MATERIALE DISPONIBILE SOLO SU RICHIESTA / ONLY ON DEMAND)

Unit: mm

FILETTO	TORSIONE Nm	CODICE	T (grip range) Min Max	A Ref	FORO +0.10	D +0.07 -0.1	B +/-0,3	K +/-0,2	L +/-0,3	Scheda Tecnica
M4	2,5	CF85ALITTGM04C	0.5-2.0	6,0	6,0	5,9	8,8	0,8	10,5	Visualizza
M5	5	CF85ALITTGM05C	0.5-2.5	7,5	7,0	6,9	10,0	1,0	13,0	Visualizza
M6	8	CF85ALITTGM06C	0.5-2.5	9,2	9,0	8,9	12,3	1,5	15,0	Visualizza
M8	20	CF85ALITTGM08C	1.0-3.0	10,2	11,0	10,9	14,3	1,5	16,5	Visualizza
M10	25	CF85ALITTG10C13	1.0-4.0	11,5	13,0	12,9	16,3	1,6	19,0	Visualizza

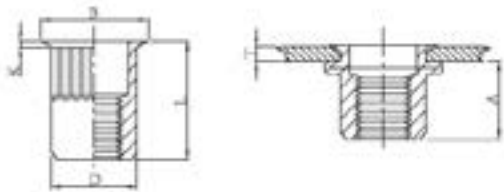

ALLUMINIO
Al Mg 2,5



(MATERIALE DISPONIBILE SOLO SU RICHIESTA / ONLY ON DEMAND)

Unit: mm

FILETTO	TORSIONE Nm	CODICE	T (grip range) Min Max	A Ref	FORO +0.10	D +0.07 -0.1	B +/-0,3	K +/-0,2	L +/-0,3	Scheda Tecnica
M4	2,5	CF85ALITRGM04C	0.5-2.0	6,0	6,0	5,9	7,0	0,5	10,5	Visualizza
M5	5	CF85ALITRGM05C	0.5-2.0	7,5	7,0	6,9	8,0	0,5	11,5	Visualizza
M6	8	CF85ALITRGM06C	0.5-2.5	9,2	9,0	8,9	10,0	0,6	14,0	Visualizza
M8	20	CF85ALITRGM08C	0.5-2.5	10,2	11,0	10,9	12,0	0,65	15,5	Visualizza
M10	25	CF85ALITRGM10C13	1.0-3.0	11,5	13,0	12,9	14,1	0,7	17,7	Visualizza

INSERTATRICE OLEOPNEUMATICA

MOD. CFRL5312

CAPACITÀ D'UTILIZZO da M3 a M12	PRESSIONE ARIA da 5 a 7 Bar	PRESSIONE NOMINALE 5,5 Bar
VELOCITÀ MOTORE 3500 giri/min	FORZA TRAZIONE 19,1 KN (4300 IBF)	RUMOROSITÀ < 75 db
PESO 2,47 Kg	CORSA 7 mm	DIMENSIONI 280x295x115

DI SERIE VIENE FORNITA CON TIRANTI INDURITI

A RICHIESTA DISPONIBILE CON VITI A ESAGONO INCASSATO
AD ALTA CLASSE RESISTENZA IN 12.9

Marchiatura CE secondo lo standard EU Nr. 2006/42/EC



Pulsante unico per
completamento ciclo



Pulsante da usare per svitamento in caso di
inceppamento inserto

INSERTATRICE A BATTERIA

MOD. CFN12XL

CAPACITÀ D'UTILIZZO da M3 a M12	MATERIALI alluminio, acciaio, inox A2/A4	
BATTERIA AL LITIO 20V / 2.0Ah	CORSA 10,0 mm	FORZA TRAZIONE 25,0 KN
RUMOROSITÀ < 75 db	PESO 2,10 Kg	MOTORE 20V senza spazzole



Impostazione
regolazione corsa



Impostazione modalità
di funzionamento manuale/automatico

DA 30 ANNI AL FIANCO DI CHI USA FASTENERS



Via delle Gallarane, 10/12 | 22046 Merone (CO)

Tel. 031 3333486 | Fax 031 3339064

C.F. | P.IVA 03228940130

www.carusofasteners.it | info@carusofasteners.it

